

PROJECT 598
NORTH ROLLA ST STORM SEWER UPGRADE

APRIL 2026



PREPARED BY:

CITY OF ROLLA PUBLIC WORKS DEPARTMENT

GENERAL NOTE:

ALL WORK SHALL BE DONE IN ADHERENCE TO THE CITY OF ROLLA STANDARDS AND SPECIFICATIONS.

CONTRACTOR SHALL PERFORM ALL WORK ASSOCIATED WITH THE PROJECT UNLESS OTHERWISE NOTED AS "BY OTHERS" BY OTHERS SHALL INCLUDE THE CITY OF ROLLA AND ALL APPROPRIATE UTILITY COMPANIES.

ALL CONSTRUCTION STAKING SHALL BE COMPLETED BY CITY PROJECT COORDINATORS UNLESS OTHERWISE SPECIFIED. NOTIFICATION OF REQUEST FOR STAKING SHALL BE SUBMITTED IN WRITING TO CITY PROJECT COORDINATOR NO LESS THAN TWO WEEKS PRIOR TO DATE NEEDED. CONSTRUCTION STAKING SHALL INCLUDE (BUT NOT BE LIMITED TO) ALIGNMENT, GRADES, FLOWLINE ELEVATIONS FOR STORM SEWER STRUCTURES, AND UTILITY ADJUSTMENTS NECESSARY FOR COMPLETION OF PROJECT.

UTILITIES ARE SHOWN FOR REFERENCE ONLY. IT SHALL BE THE CONTRACTORS RESPONSIBILITY TO CONTACT ALL UTILITY COMPANIES PRIOR TO CONSTRUCTION FOR A FIELD LOCATE TO VERIFY THE DEPTH AND POSITION OF THE RESPECTIVE UTILITY.

STREET LANE RESTRICTIONS AND/OR CLOSINGS SHALL BE COORDINATED WITH THE CITY OF ROLLA STREET DEPARTMENT.

ALL EXCAVATIONS MUST BE CLOSED AT THE END OF EACH DAY OR MUST BE FENCED TO PREVENT INJURY TO PERSONS AND/OR PROPERTY.

SEEDING AND MULCHING OF ALL DISTURBED AREAS SHALL BE BY OTHERS.

ALL TREE REMOVAL SHALL BE BY OTHERS. ALL CLEARING, GRUBBING AND DISPOSAL OF TREES, BRUSH, AND DEBRIS SHALL BE BY OTHERS.

RESTORATION OF EXISTING GRAVEL DRIVES AND DRIVEWAYS TO PRECONSTRUCTION CONDITION AND GRADE SHALL BE BY OTHERS.

ROAD SHALL BE OPEN TO LOCAL TRAFFIC AND CLOSED TO THROUGH TRAFFIC. DETOUR ROUTE SHALL BE DETERMINED IN COORDINATION WITH THE PUBLIC WORKS DEPARTMENT. CONTRACTOR SHALL BE RESPONSIBLE FOR PLACING AND MAINTAINING ALL SIGNAGE AND BARRICADES NECESSARY TO CARRY OUT DETOUR PLAN.

TRAFFIC CONTROL/SAFETY SHALL BE STRICTLY ENFORCED. DEMOBILIZATION AND REMOBILIZATION FEES WILL NOT BE REIMBURSED UNDER ANY CIRCUMSTANCES.

CONTRACTOR SHALL BE RESPONSIBLE FOR MONITORING AND MAINTAINING FINAL GRADE SURFACE UNTIL SUCH TIME AS CONCRETE CAN BE LAID.

CONTRACTOR SHALL BE RESPONSIBLE FOR BARRICADING ALL WATER VALVES AND MANHOLES TO PREVENT PERSONAL INJURY OR PROPERTY DAMAGE BY OTHERS.

ALL WORK DONE ON STATE RIGHT OF WAY SHALL BE COORDINATED THROUGH MODOT. LANE CLOSURES SHALL FOLLOW MODOT SPECIFICATIONS FOR TRAFFIC CONTROL.

CONTRACTOR SHALL CONTACT PROPERTY OWNER PRIOR TO CONSTRUCTION OF NEW DRIVEWAYS TO AVOID CONFINING VEHICLES DURING CONSTRUCTION

UNIT PRICE FOR INSTALLATION OF CURB, DRIVEWAY APRONS AND SIDEWALK SHALL INCLUDE ALL CONCRETE, LABOR, FORMS AND EQUIPMENT NECESSARY FOR THE COMPLETE INSTALLATION OF THE ITEM. ROCK SHALL BE FURNISHED BY THE CITY OF ROLLA.

EROSION CONTROL NOTE:
EROSION CONTROL SHALL BE BY CITY.

INDEX

1	KEY SHEET
2	PLAN & PROFILE - 10th St to 11th St
3	PLAN & PROFILE - 10th St from Main St to Rolla St
4	PLAN & PROFILE - 10th St from Rolla St to Pine St
5	PLAN & PROFILE - 9th St to 10th St
6	PLAN & PROFILE - 9th St from Main St to Rolla St
7	PLAN & PROFILE - 9th St from Rolla St to Pine St
8	PLAN & PROFILE - Rolla St from 8th St to 9th St
9	PLAN & PROFILE - 8th St from Rolla St to Pine St
10	PLAN & PROFILE - Rolla St from 7th St to 8th St
11	PLAN & PROFILE - 7th St from Main St to Rolla St
12	PLAN & PROFILE - 7th St from Rolla St to Main St
13	PLAN & PROFILE - Rolla St from 6th St to 7th St
14	PLAN & PROFILE - 6th St from Rolla St to Main St
15	PLAN & PROFILE - 6th St from Rolla St to Pine St
16	PLAN & PROFILE - Rolla St from 5th St to 6th St
17	ASPHALT EXTENTS PLAN
18-24	STANDARD DETAILS

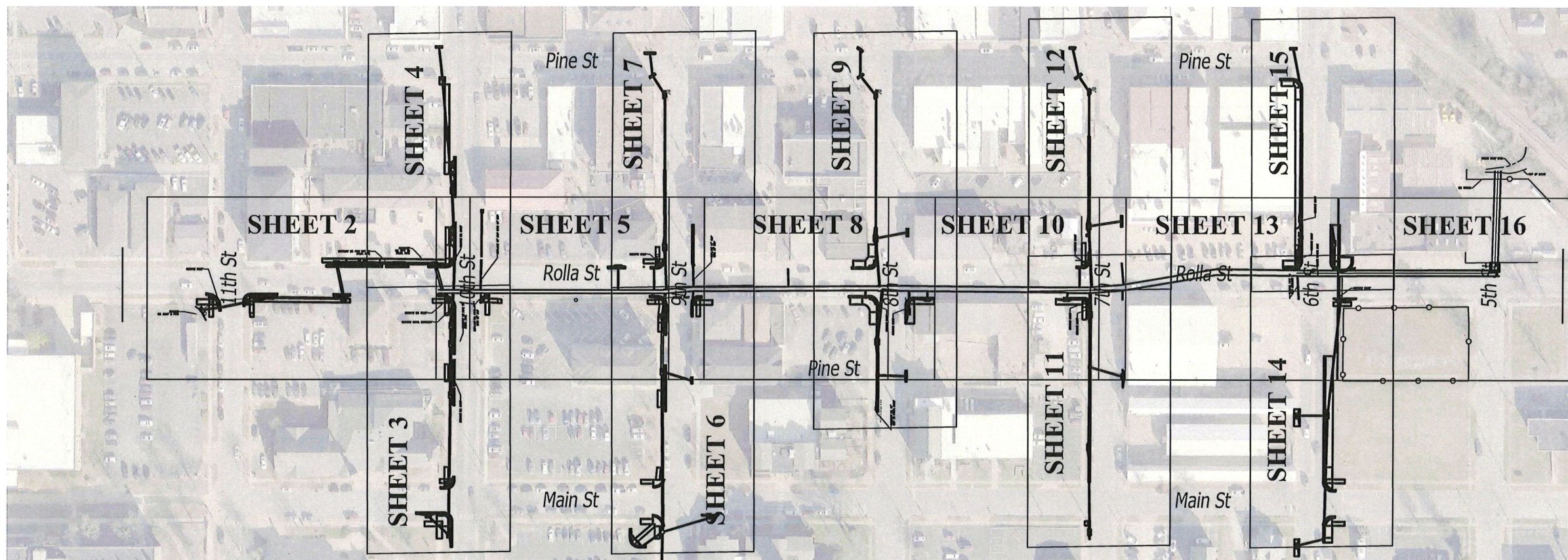

LEGEND

<ul style="list-style-type: none"> ⊕ - EXISTING FIRE HYDRANT ⊕ - EXISTING WATER VALVE ⊕ - EXISTING WATER METER ⊕ - EXISTING UTILITY POLE WITH GUY WIRE ⊕ - EXISTING SANITARY SEWER MANHOLE ⊕ - PROPOSED SANITARY SEWER MANHOLE ⊕ - EXISTING SIGN ⊕ - EXISTING STORM INLET ⊕ - PROPOSED STORM INLET ⊕ - EXISTING SANITARY SEWER CLEANOUT ⊕ - EXISTING STREET LIGHT 	<ul style="list-style-type: none"> SS - PROPOSED SANITARY SEWER SS - EXISTING SANITARY SEWER OHE - EXISTING OVERHEAD ELECTRIC FO - EXISTING FIBER OPTIC LINE WL - EXISTING WATER LINE GAS - EXISTING GAS LINE SS - EXISTING STORM SEWER --- - EXISTING CHAIN LINK FENCE --- - RIGHT-OF-WAY/PROPERTY LINE ⊕ - PROPOSED TRUNCATED DOMES ⊕ - EXISTING TREE
--	--



UTILITIES

DIGRITE		
STREET/SEWER -	CITY OF ROLLA PUBLIC WORKS DEPARTMENT	573-364-8659
WATER/ELECTRIC -	ROLLA MUNICIPAL UTILITIES	573-364-1572
NATURAL GAS -	AMEREN MISSOURI	573-368-3440
TELEPHONE -	EMERGENCY	1-800-552-7583
TELEPHONE -	CENTURY/LINK	573-341-0405
FIDELITY CABLEVISION INC.		573-426-6111
MODOT		
MISSOURI DEPT OF TRANSPORTATION		
PERMIT INSPECTOR - KIM HILBURN		573-368-2575
SIGNAL MAINTENANCE SHED - STEVE HELTON		573-364-2218
ASK MODOT		1-888-275-6636
CENTRAL DISTRICT-JEFFERSON CITY		573-751-3322

Date		Description		Rev.	
Designed: CAF	Date: APRIL 2026	Drawn: CAF	Scale: NTS	Checked: MBK	Proj. No.: 598
City of Rolla Department of Public Works 901 North Elm Street Phone: 573-364-8659 www.rollacity.org					
ROLLA STREET STORM SEWER UPGRADE City of Rolla Public Works Department Key Sheet					
Sheet No.:					
1					

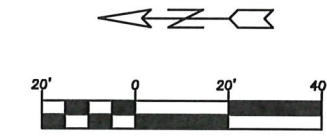
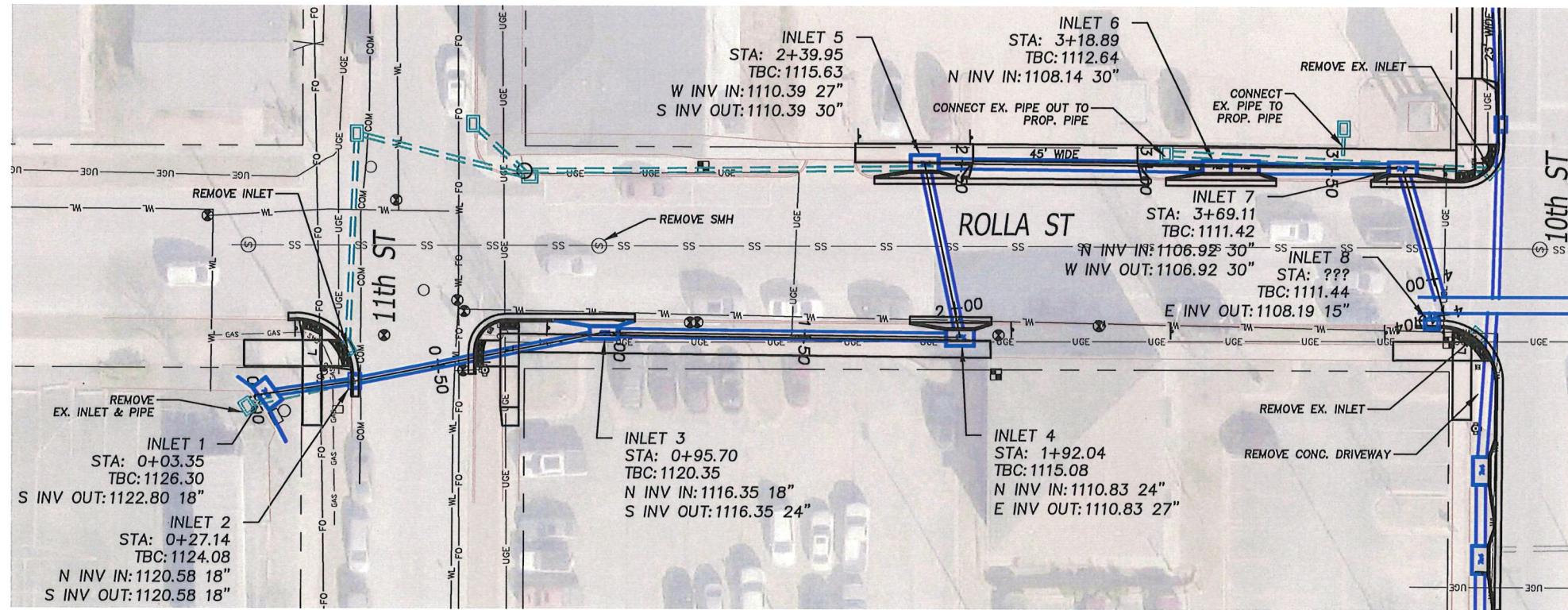

1 ROLLA STREET STORM PLAN - 10th St to 11th St
2 Scale: 1" = 40' H

KEYED NOTES

- 1. CONTRACTOR SHALL ENSURE THAT ALL SPECIFIED TRAFFIC SIGNS REMAIN IN PLACE DURING CONSTRUCTION AND REMAIN VISIBLE AT ALL TIMES. CONTRACTOR SHALL INSTALL SIGN POST SLEEVES FOR SIGN UPGRADES AND RELOCATIONS.
- 2. ADJUST MANHOLE LID AND RING AS NEEDED BY OTHERS.
- 3. ADJUST WATER VALVE AS NEEDED BY OTHERS. CONTACT ROLLA MUNICIPAL UTILITIES REPRESENTATIVE FOR STANDARD DETAILS.
- 4. REMOVE AND DISCARD EXISTING DRAIN PIPE BY OTHERS.
- 5. CONTRACTOR SHALL ENSURE ALL PROPERTY PINS, RIGHT-OF-WAY MARKERS, MONUMENTS AND BENCH MARKS REMAIN UNDISTURBED AS PER MISSOURI REVISED STATUTES, CHAPTER 60 "COUNTY SURVEYORS AND LAND SURVEYS", SECTION 60.355. CONTRACTOR SHALL BE AWARE THAT VIOLATION OF THIS STATUTE IS CONSIDERED A CLASS B MISDEMEANOR. CONTRACTOR SHALL BE RESPONSIBLE FOR ALL COSTS ASSOCIATED WITH REESTABLISHMENT OF MONUMENTS OR MARKERS DISTURBED DURING CONSTRUCTION.
- 6. REMOVE AND RELOCATE EXISTING MAILBOXES BY OTHERS. CONTRACTOR SHALL ENSURE POSTAL SERVICE IS UNINTERRUPTED.
- 7. SAWCUT ASPHALT AT MATCH LINES BY OTHERS.

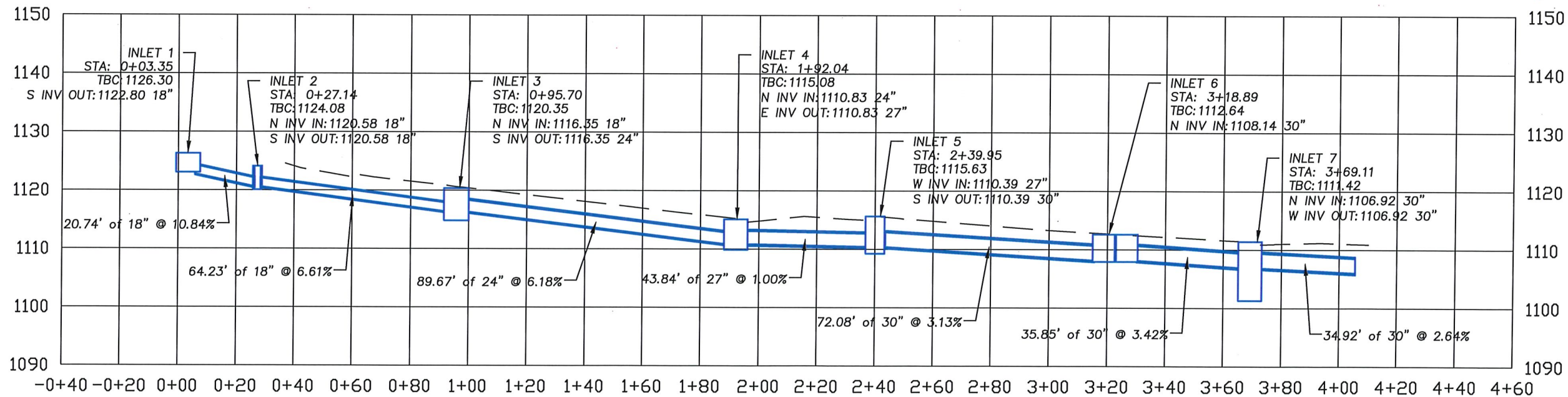

2 ROLLA STREET STORM PROFILE - 10th St to 11th St
2 Scale: 1" = 40' H
 1" = 20' V

Date	APRIL 2026
Description	ROLLA STREET STORM SEWER UPGRADE
Rev.	
Designed: CAF	Scale: 1" = 40'
Drawn: CAF	Proj. No.: 598
Checked: MBK	
City of Rolla Department of Public Works 901 North Elm Street Phone: 573-564-8659 www.rollacity.org	
Storm Plan & Profile	
Sheet No.:	2

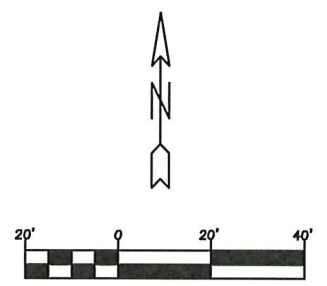
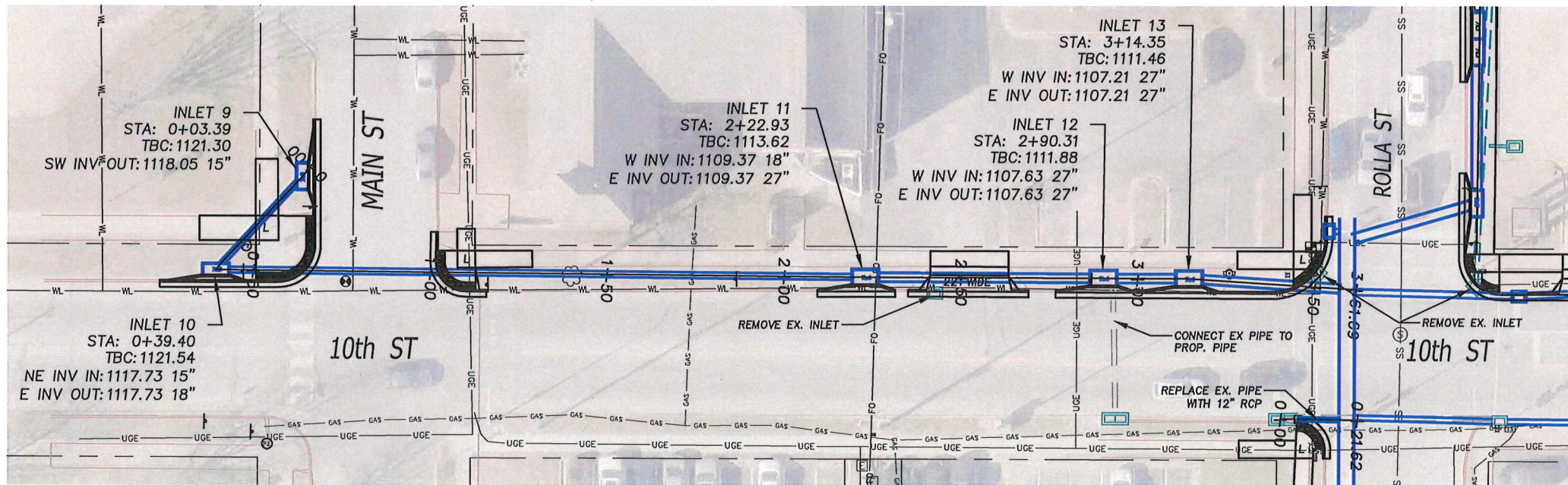

1 ROLLA STREET STORM PLAN - 10th St from Main St to Rolla St
3 Scale: 1" = 40' H

KEYED NOTES

- 1 CONTRACTOR SHALL ENSURE THAT ALL SPECIFIED TRAFFIC SIGNS REMAIN IN PLACE DURING CONSTRUCTION AND REMAIN VISIBLE AT ALL TIMES. CONTRACTOR SHALL INSTALL SIGN POST SLEEVES FOR SIGN UPGRADES AND RELOCATIONS.
- 2 ADJUST MANHOLE LID AND RING AS NEEDED BY OTHERS.
- 3 ADJUST WATER VALVE AS NEEDED BY OTHERS. CONTACT ROLLA MUNICIPAL UTILITIES REPRESENTATIVE FOR STANDARD DETAILS.
- 4 REMOVE AND DISCARD EXISTING DRAIN PIPE BY OTHERS.
- 5 CONTRACTOR SHALL ENSURE ALL PROPERTY PINS, RIGHT-OF-WAY MARKERS, MONUMENTS AND BENCH MARKS REMAIN UNDISTURBED AS PER MISSOURI REVISED STATUTES, CHAPTER 60 "COUNTY SURVEYS AND LAND SURVEYS", SECTION 60.355. CONTRACTOR SHALL BE AWARE THAT VIOLATION OF THIS STATUTE IS CONSIDERED A CLASS B MISDEMEANOR. CONTRACTOR SHALL BE RESPONSIBLE FOR ALL COSTS ASSOCIATED WITH REESTABLISHMENT OF MONUMENTS OR MARKERS DISTURBED DURING CONSTRUCTION.
- 6 REMOVE AND RELOCATE EXISTING MAILBOXES BY OTHERS. CONTRACTOR SHALL ENSURE POSTAL SERVICE IS UNINTERRUPTED.
- 7 SAWCUT ASPHALT AT MATCH LINES BY OTHERS.

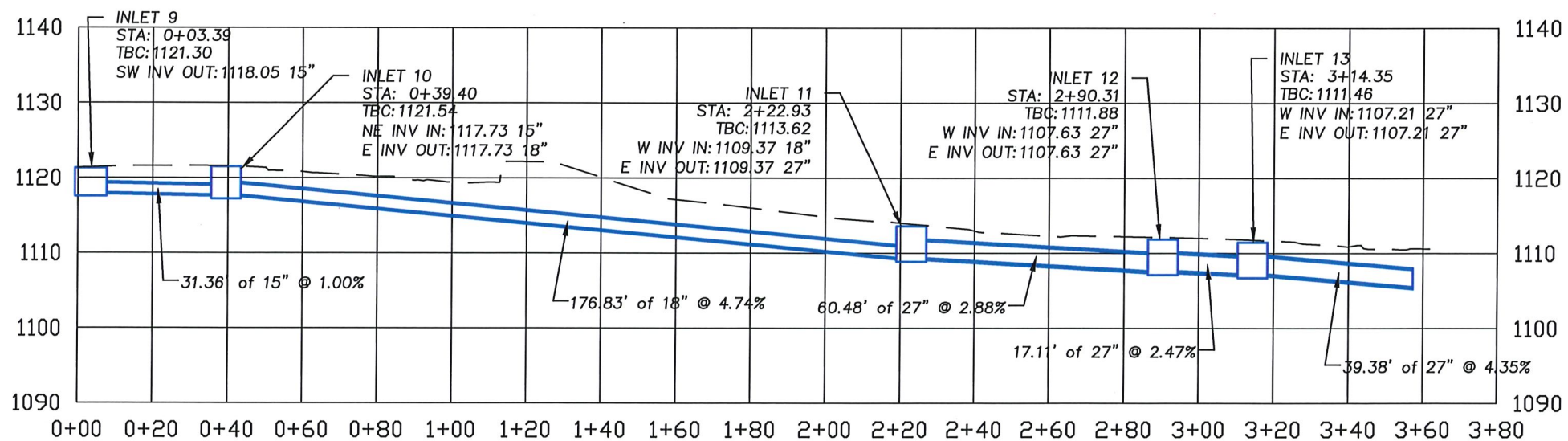

2 ROLLA STREET STORM PROFILE - 10th St from Main St to Rolla St
3 Scale: 1" = 40' H
 1" = 20' V

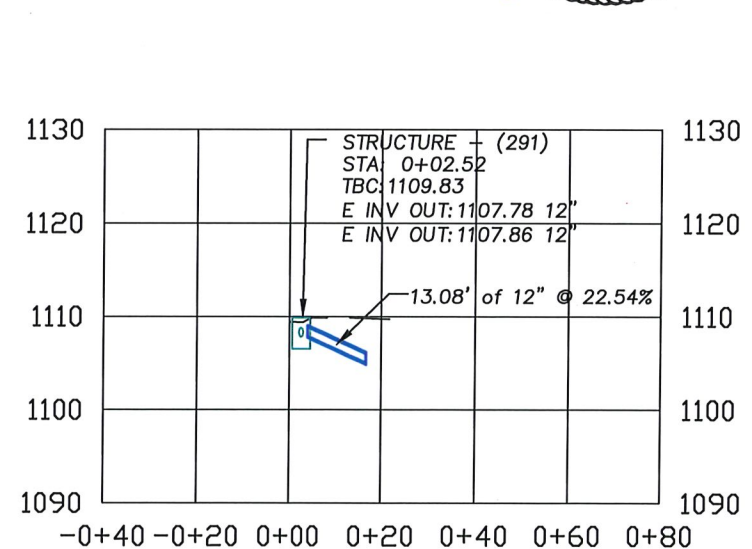

3 ROLLA STREET STORM PROFILE - 10th St & Rolla St SW Curb Return
3 Scale: 1" = 40' H
 1" = 20' V

Date	APRIL 2026
Description	ROLLA STREET STORM SEWER UPGRADE
Rev.	
Designed: CAF	Scale: 1" = 40'
Drawn: CAF	Proj. No.: 598
Checked: MBK	
City of Rolla Department of Public Works 901 North Elm Street Phone: 573-364-8659 www.rollacity.org	
Storm Plan & Profile	
Sheet No.: 3	

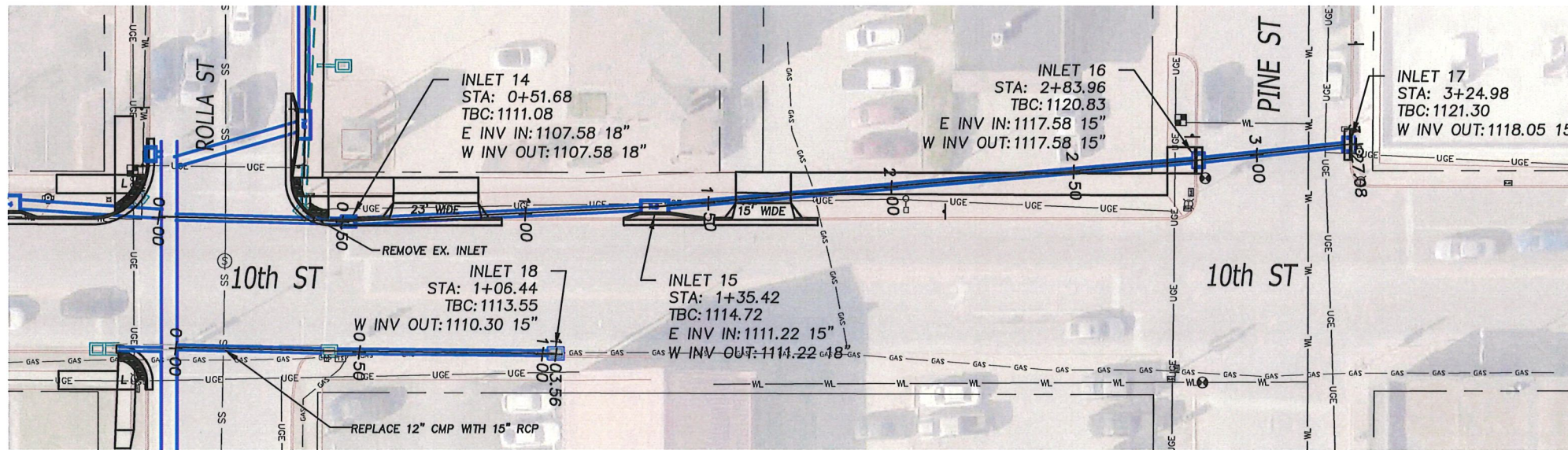

1 ROLLA STREET STORM PLAN - 10th St from Rolla St to Pine St
 Scale: 1" = 40' H

KEYED NOTES

- 1 CONTRACTOR SHALL ENSURE THAT ALL SPECIFIED TRAFFIC SIGNS REMAIN IN PLACE DURING CONSTRUCTION AND REMAIN VISIBLE AT ALL TIMES. CONTRACTOR SHALL INSTALL SIGN POST SLEEVES FOR SIGN UPGRADES AND RELOCATIONS.
- 2 ADJUST MANHOLE LID AND RING AS NEEDED BY OTHERS.
- 3 ADJUST WATER VALVE AS NEEDED BY OTHERS. CONTACT ROLLA MUNICIPAL UTILITIES REPRESENTATIVE FOR STANDARD DETAILS.
- 4 REMOVE AND DISCARD EXISTING DRAIN PIPE BY OTHERS.

- 1 CONTRACTOR SHALL ENSURE ALL PROPERTY PINS, RIGHT-OF-WAY MARKERS, MONUMENTS AND BENCH MARKS REMAIN UNDISTURBED AS PER MISSOURI REVISED STATUTES, CHAPTER 60 "COUNTY SURVEYORS AND LAND SURVEYS", SECTION 60.355. CONTRACTOR SHALL BE AWARE THAT VIOLATION OF THIS STATUTE IS CONSIDERED A CLASS B MISDEMEANOR. CONTRACTOR SHALL BE RESPONSIBLE FOR ALL COSTS ASSOCIATED WITH REESTABLISHMENT OF MONUMENTS OR MARKERS DISTURBED DURING CONSTRUCTION.
- 2 REMOVE AND RELOCATE EXISTING MAILBOXES BY OTHERS. CONTRACTOR SHALL ENSURE POSTAL SERVICE IS UNINTERRUPTED.
- 3 SAWCUT ASPHALT AT MATCH LINES BY OTHERS.

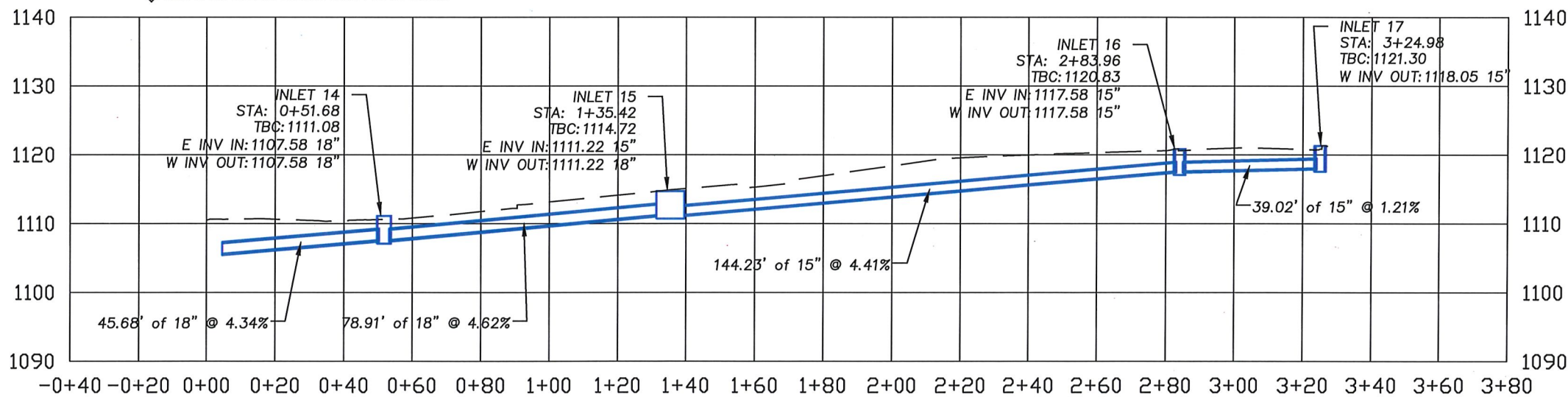
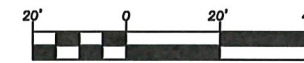

2 ROLLA STREET STORM PROFILE - Station 0+00 to Station 5+00
 Scale: 1" = 40' H
 1" = 20' V

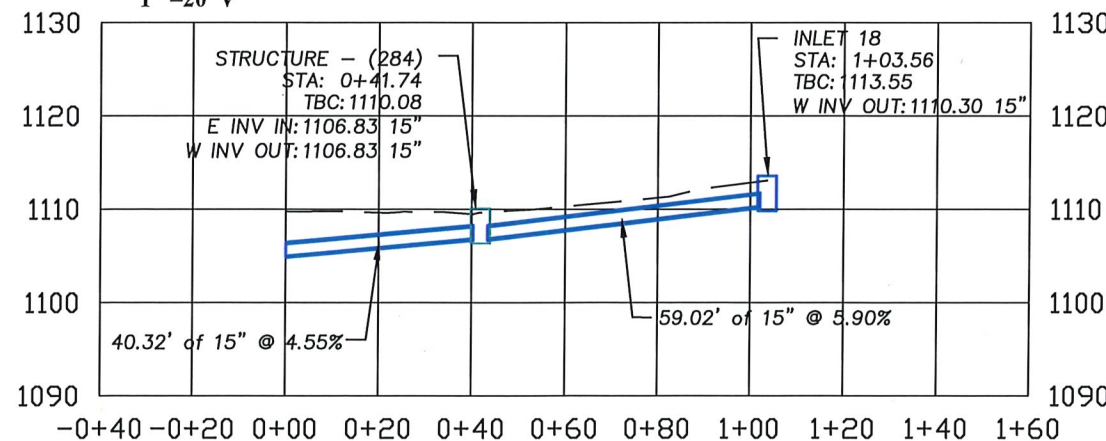

3 ROLLA STREET STORM PROFILE - 10th St & Rolla St SE Curb Return
 Scale: 1" = 40' H
 1" = 20' V



Rev.	Description	Date

Designed: CAF Date: APRIL 2026
 Drawn: CAF Scale: 1" = 40'
 Checked: MBK Proj. No.: 598

City of Rolla
 Department of Public Works
 901 North Elm Street
 Phone: 573-364-8659
 www.rollacity.org

ROLLA

ROLLA STREET STORM SEWER UPGRADE
 City of Rolla Public Works Department
 Storm Plan & Profile

Sheet No.: **4**

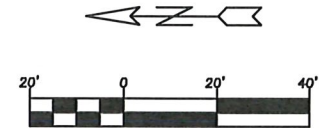
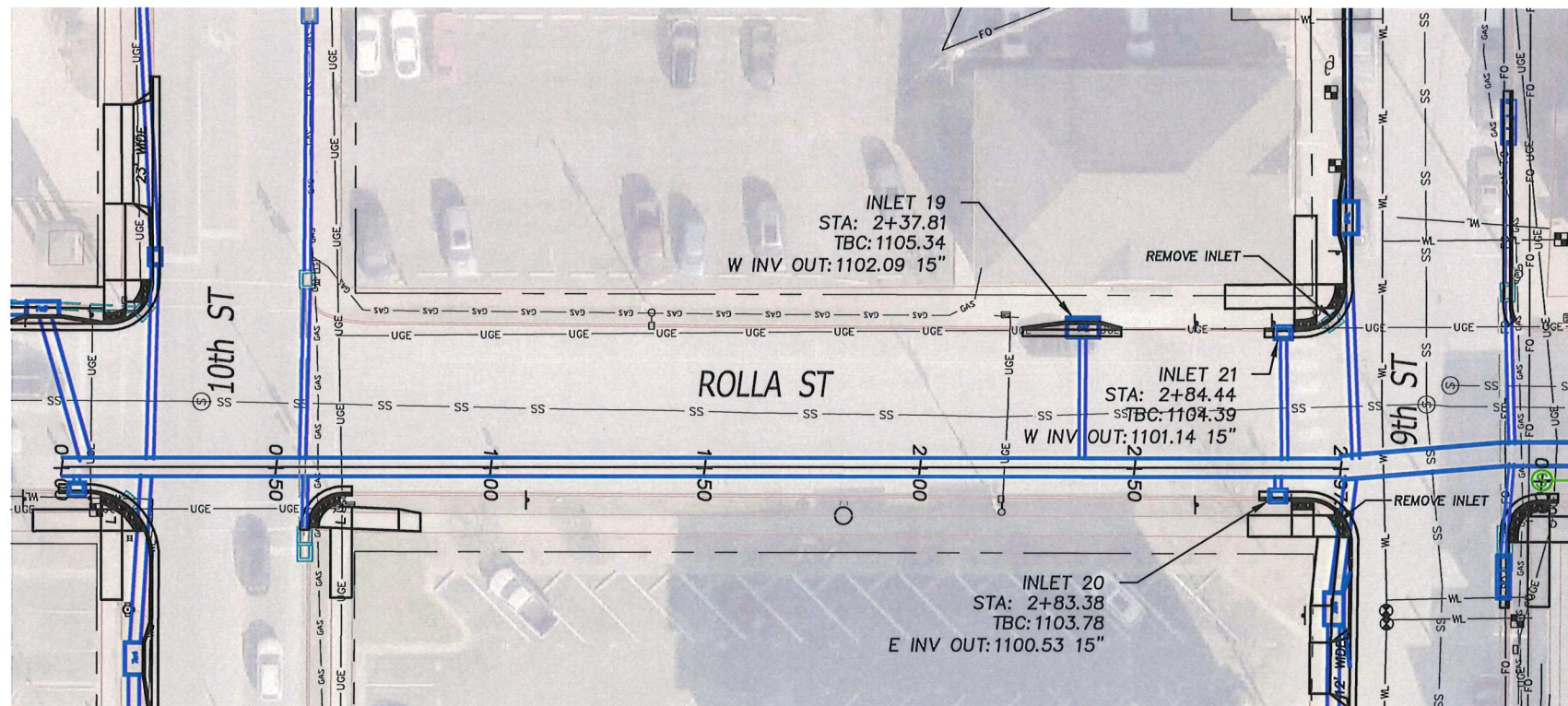

1
5 ROLLA STREET STORM PLAN - Rolla St from 9th St to 10th St
Scale: 1" = 40' H

KEYED NOTES

- ① CONTRACTOR SHALL ENSURE THAT ALL SPECIFIED TRAFFIC SIGNS REMAIN IN PLACE DURING CONSTRUCTION AND REMAIN VISIBLE AT ALL TIMES. CONTRACTOR SHALL INSTALL SIGN POST SLEEVES FOR SIGN UPGRADES AND RELOCATIONS.
- ② ADJUST MANHOLE LID AND RING AS NEEDED BY OTHERS.
- ③ ADJUST WATER VALVE AS NEEDED BY OTHERS. CONTACT ROLLA MUNICIPAL UTILITIES REPRESENTATIVE FOR STANDARD DETAILS.
- ④ REMOVE AND DISCARD EXISTING DRAIN PIPE BY OTHERS.
- ⑤ CONTRACTOR SHALL ENSURE ALL PROPERTY PINS, RIGHT-OF-WAY MARKERS, MONUMENTS AND BENCH MARKS REMAIN UNDISTURBED AS PER MISSOURI REVISED STATUTES, CHAPTER 60 "COUNTY SURVEYORS AND LAND SURVEYS", SECTION 60.355. CONTRACTOR SHALL BE AWARE THAT VIOLATION OF THIS STATUTE IS CONSIDERED A CLASS B MISDEMEANOR. CONTRACTOR SHALL BE RESPONSIBLE FOR ALL COSTS ASSOCIATED WITH REESTABLISHMENT OF MONUMENTS OR MARKERS DISTURBED DURING CONSTRUCTION.
- ⑥ REMOVE AND RELOCATE EXISTING MAILBOXES BY OTHERS. CONTRACTOR SHALL ENSURE POSTAL SERVICE IS UNINTERRUPTED.
- ⑦ SAWCUT ASPHALT AT MATCH LINES BY OTHERS.

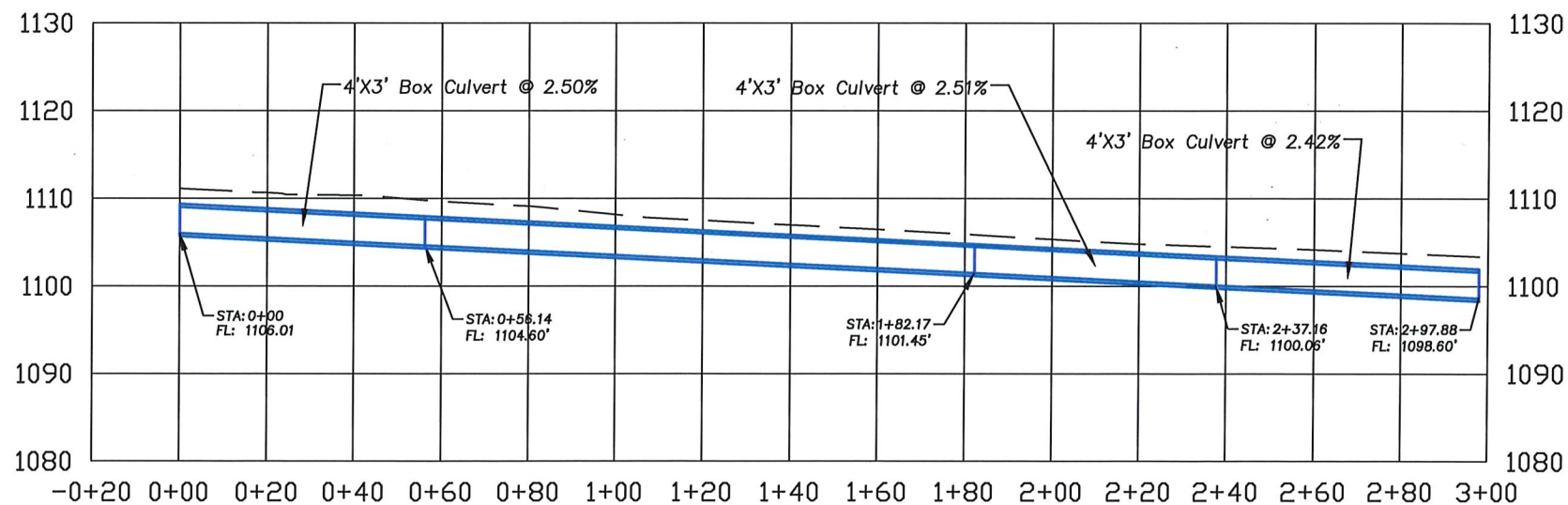

2
5 ROLLA STREET STORM PROFILE - Rolla St from 9th St to 10th St
Scale: 1" = 40' H
1" = 20' V



City of Rolla Department of Public Works 901 North Elm Street Phone: 573-364-8659 www.rollacity.org	Designed: CAF Drawn: CAF Checked: MBK	Date: APRIL 2026 Scale: 1" = 40' Proj. No.: 598
ROLLA STREET STORM SEWER UPGRADE City of Rolla Public Works Department Storm Plan & Profile		
Sheet No.:		
5		

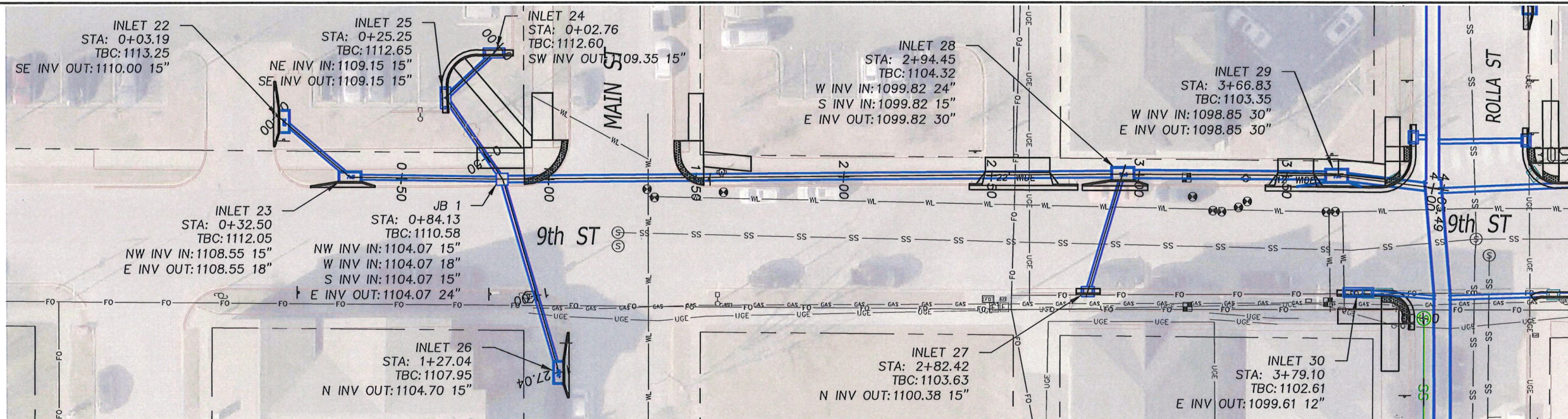

1 ROLLA STREET STORM PLAN - 9th St from Main St to Rolla St
 Scale: 1" = 40' H

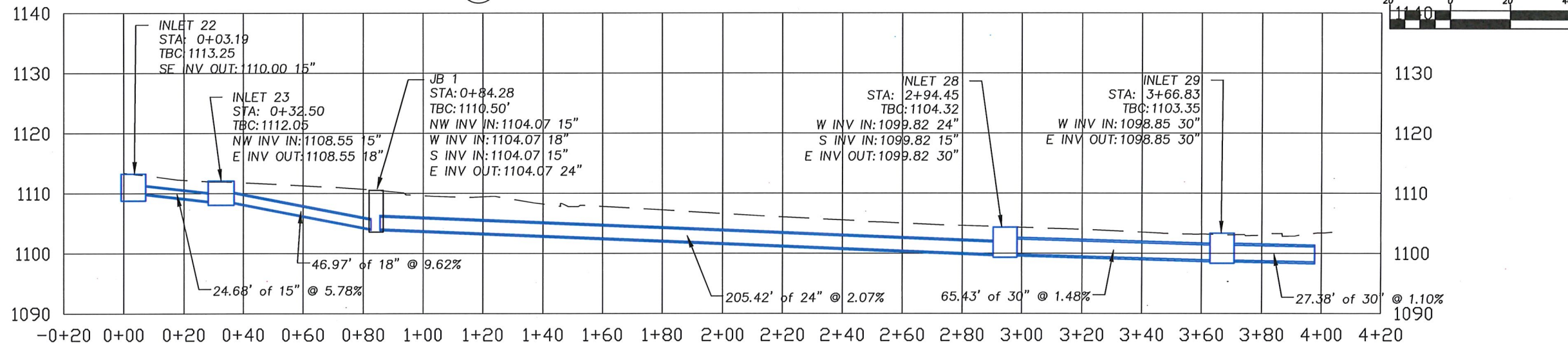

2 ROLLA STREET STORM PLAN - 9th St from Main St to Rolla St
 Scale: 1" = 40' H

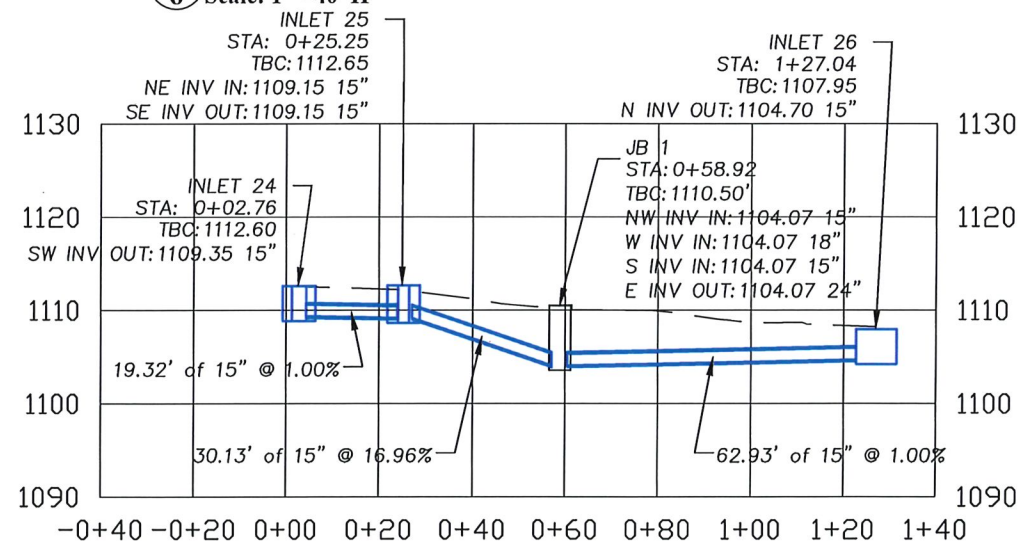

3 ROLLA STREET STORM PROFILE - 9th St and Main St
 Scale: 1" = 40' H



Rev.	Description	Date

Designed: CAF Date: APRIL 2026
 Drawn: CAF Scale: 1" = 40'
 Checked: MBK Proj. No.: 598

City of Rolla
 Department of Public Works
 901 North Elm Street
 Phone: 573-364-8659
 www.rollacity.org

ROLLA

ROLLA STREET STORM SEWER UPGRADE
 City of Rolla Public Works Department
 Storm Plan & Profile

Sheet No.: **6**

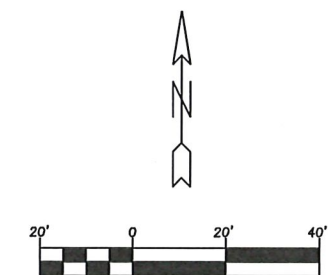
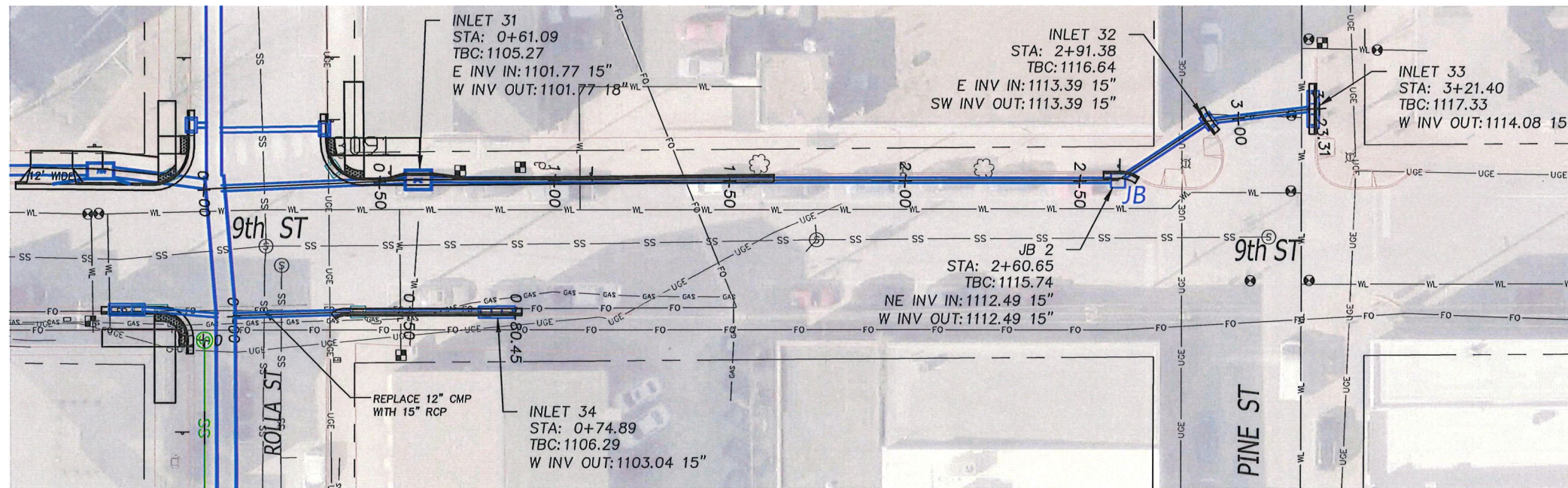

1 ROLLA STREET STORM PLAN - 9th St from Rolla St to Pine St
 Scale: 1" = 40' H

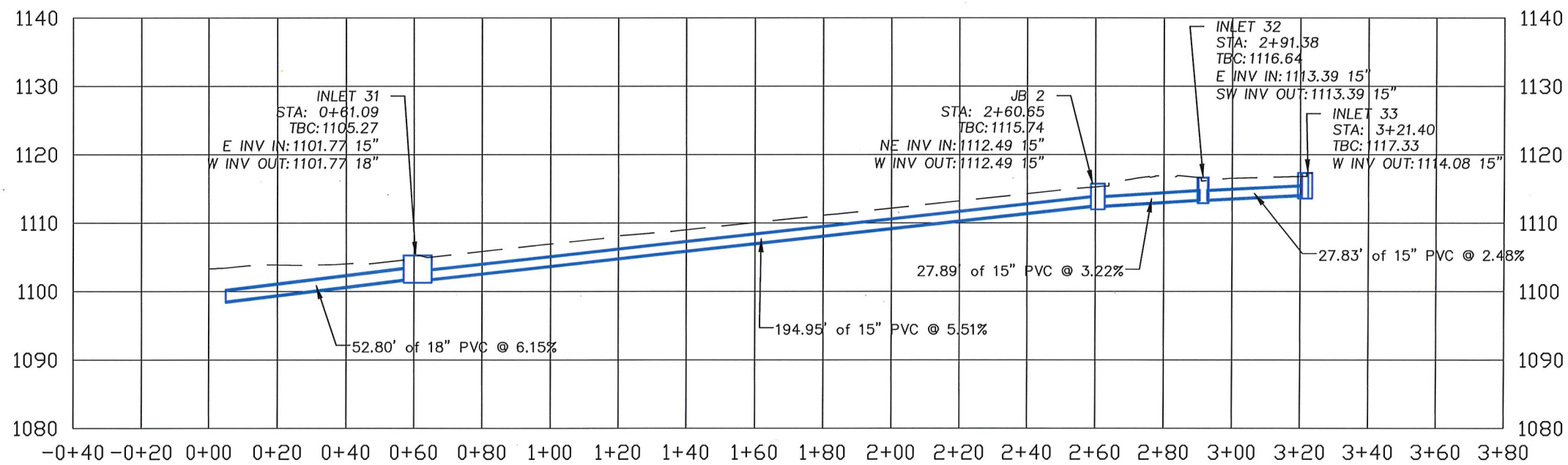

2 ROLLA STREET STORM PROFILE - 9th St from Rolla St to Pine St
 Scale: 1" = 40' H

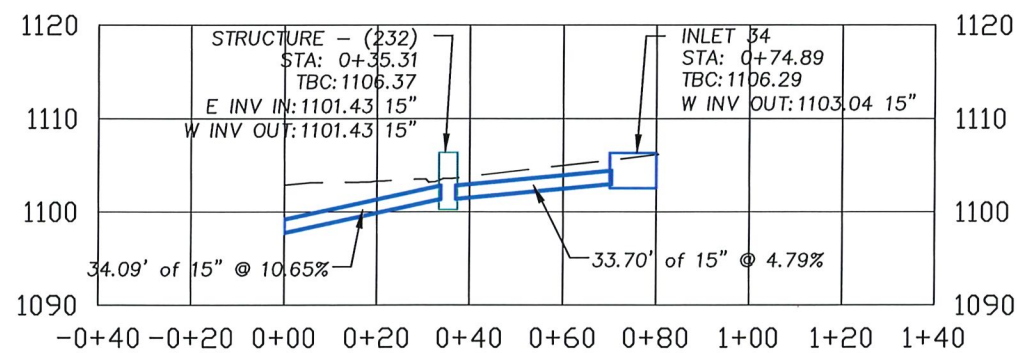

3 ROLLA STREET STORM PROFILE - Rolla St and 9th St
 Scale: 1" = 40' H



Rev.	Description	Date

Designed: CAF	Date: APRIL 2026
Drawn: CAF	Scale: 1" = 40'
Checked: MBK	Proj. No.: 598

City of Rolla
 Department of Public Works
 901 North Elm Street
 Phone: 573-364-8659
 www.rollacity.org

ROLLA

ROLLA STREET STORM SEWER UPGRADE
 City of Rolla Public Works Department
 Storm Plan & Profile

Sheet No.: **7**

SEE SHEET 4

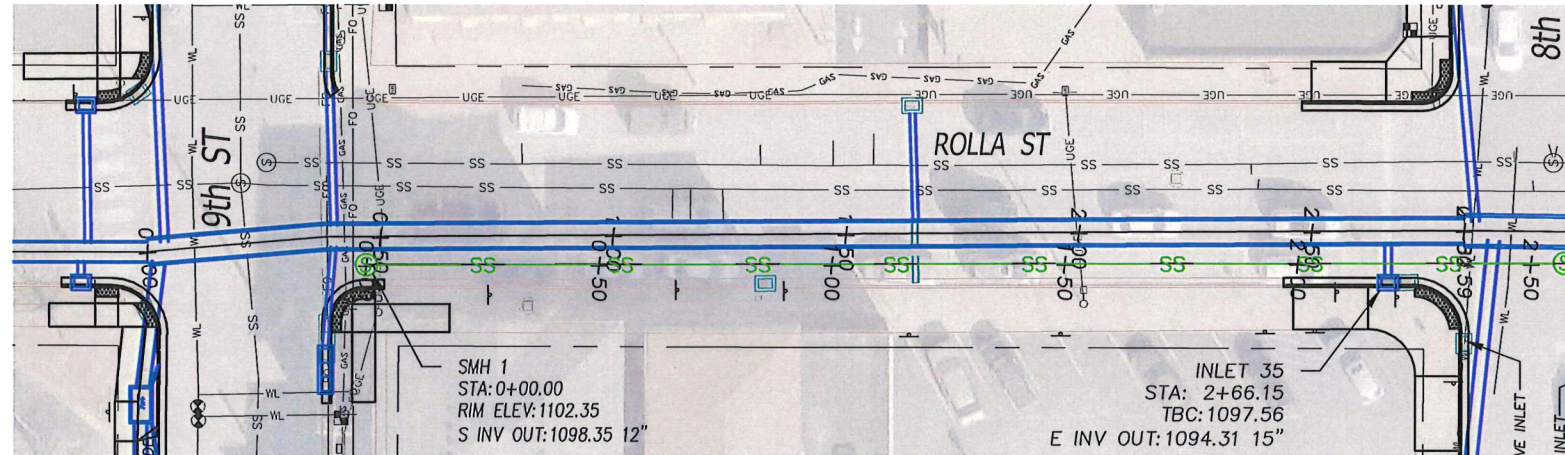

1
8 ROLLA STREET STORM PLAN - Rolla St from 8th St to 9th St
Scale: 1" = 40' H

KEYED NOTES

- 1 CONTRACTOR SHALL ENSURE THAT ALL SPECIFIED TRAFFIC SIGNS REMAIN IN PLACE DURING CONSTRUCTION AND REMAIN VISIBLE AT ALL TIMES. CONTRACTOR SHALL INSTALL SIGN POST SLEEVES FOR SIGN UPGRADES AND RELOCATIONS.
- 2 ADJUST MANHOLE LID AND RING AS NEEDED BY OTHERS.
- 3 ADJUST WATER VALVE AS NEEDED BY OTHERS. CONTACT ROLLA MUNICIPAL UTILITIES REPRESENTATIVE FOR STANDARD DETAILS.
- 4 REMOVE AND DISCARD EXISTING DRAIN PIPE BY OTHERS.
- 5 CONTRACTOR SHALL ENSURE ALL PROPERTY PINS, RIGHT-OF-WAY MARKERS, MONUMENTS AND BENCH MARKS REMAIN UNDISTURBED AS PER MISSOURI REVISED STATUTES, CHAPTER 60 "COUNTY SURVEYORS AND LAND SURVEYS", SECTION 60.355. CONTRACTOR SHALL BE AWARE THAT VIOLATION OF THIS STATUTE IS CONSIDERED A CLASS B MISDEMEANOR. CONTRACTOR SHALL BE RESPONSIBLE FOR ALL COSTS ASSOCIATED WITH REESTABLISHMENT OF MONUMENTS OR MARKERS DISTURBED DURING CONSTRUCTION.
- 6 REMOVE AND RELOCATE EXISTING MAILBOXES BY OTHERS. CONTRACTOR SHALL ENSURE POSTAL SERVICE IS UNINTERRUPTED.
- 7 SAWCUT ASPHALT AT MATCH LINES BY OTHERS.

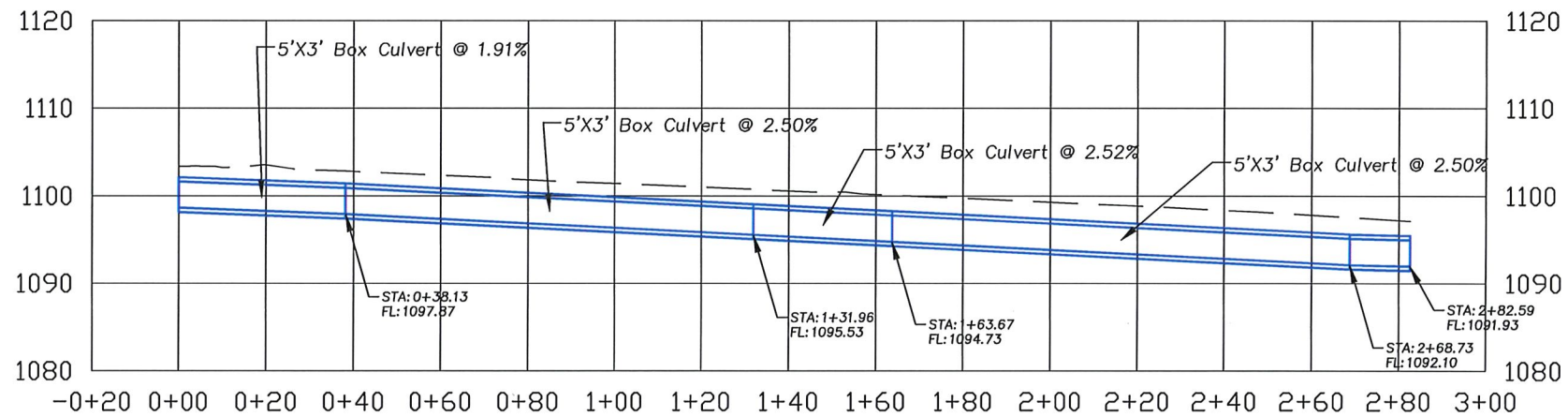

2
8 ROLLA STREET STORM PROFILE - Rolla St from 8th St to 9th St
Scale: 1" = 40' H
1" = 20' V

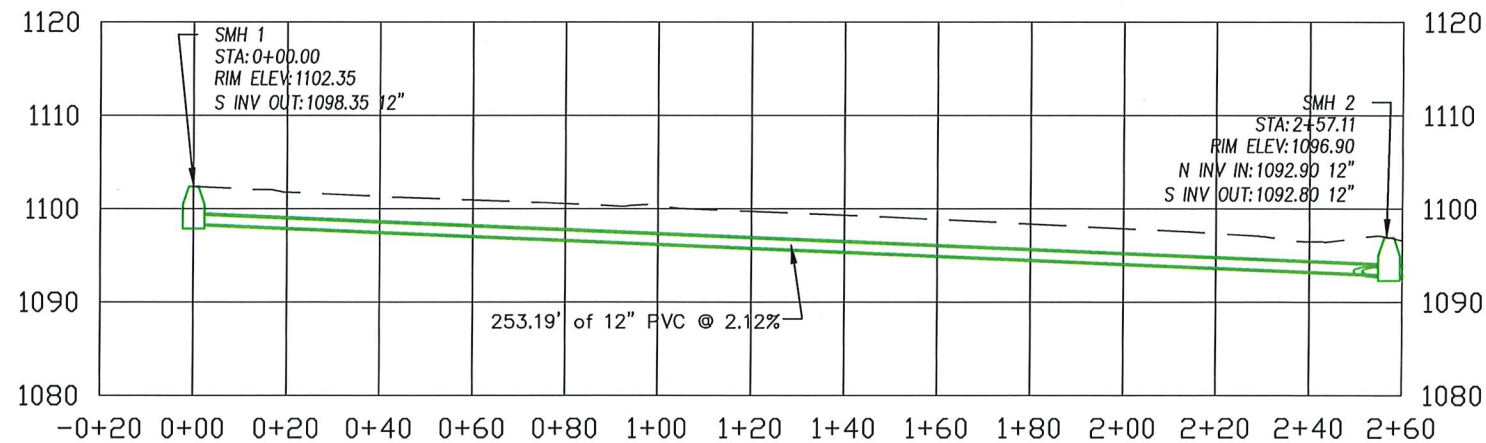

3
8 ROLLA STREET SANITARY PROFILE - Rolla St from 8th St to 9th St
Scale: 1" = 40' H
1" = 20' V



Rev.	Description	Date

Designed: CAF Date: APRIL 2026
 Drawn: CAF Scale: 1" = 40'
 Checked: MBK Proj. No.: 598

City of Rolla
 Department of Public Works
 901 North Elm Street
 Phone: 573-364-8659
 www.rollacity.org

ROLLA

ROLLA STREET STORM SEWER UPGRADE
 City of Rolla Public Works Department
 Storm & Sanitary Plan & Profile

Sheet No.: **8**

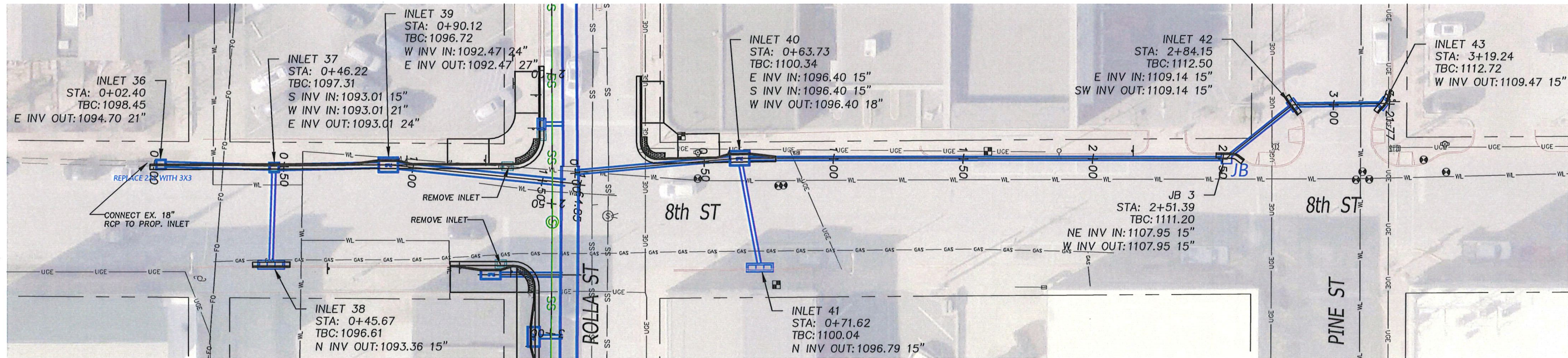

1
9 ROLLA STREET STORM PLAN - 8th St from Rolla St to Pine St
Scale: 1" = 40' H

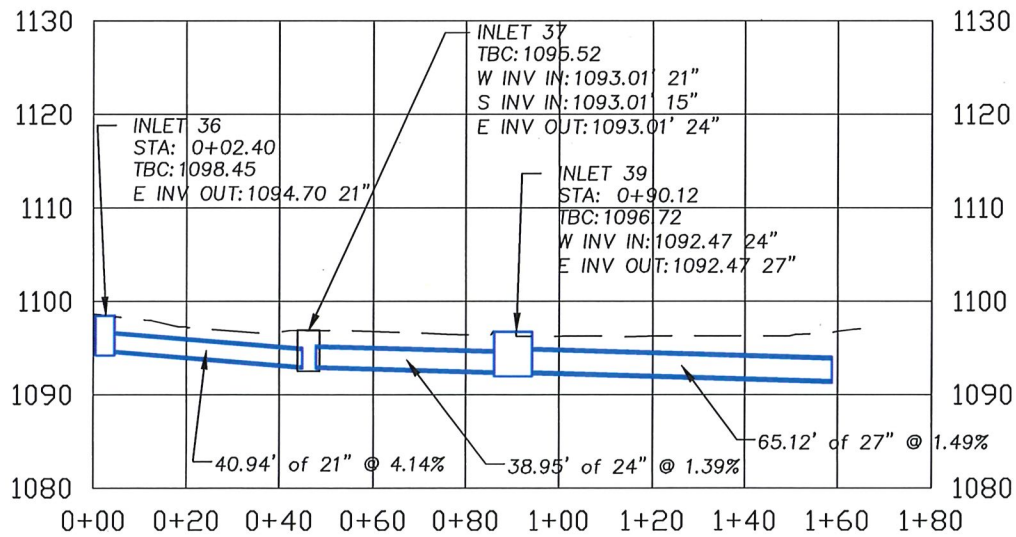

2
9 ROLLA STREET STORM PROFILE - Rolla St and 8th St
Scale: 1" = 40' H
1" = 20' V

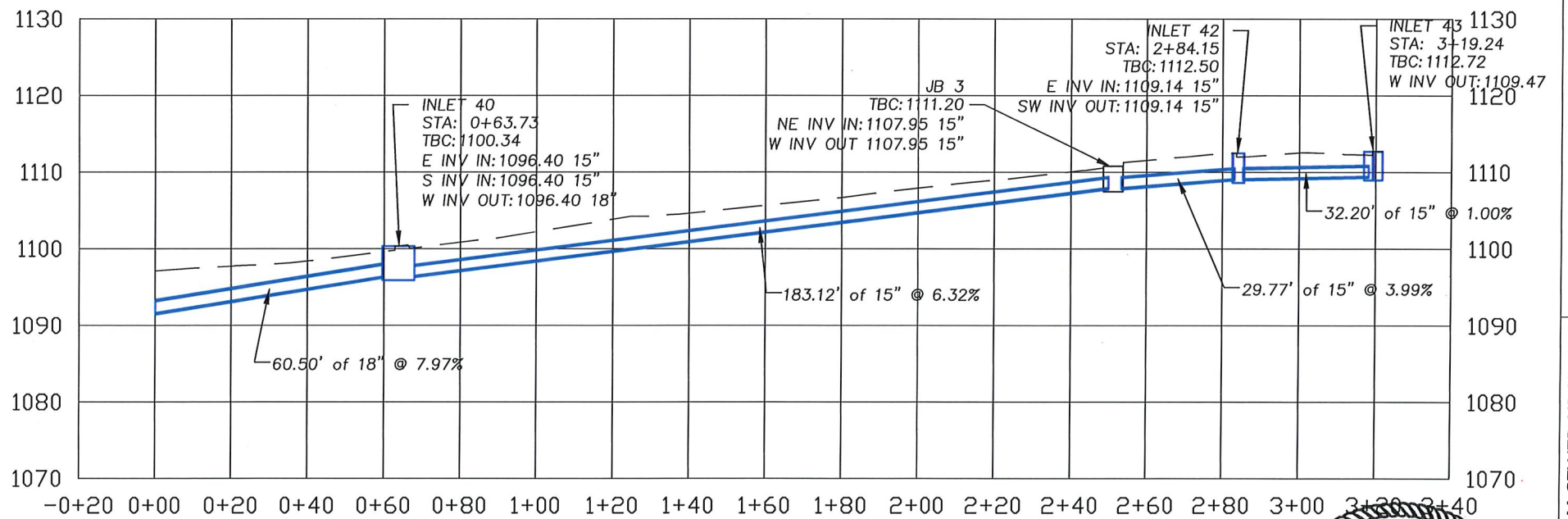

3
9 ROLLA STREET STORM PROFILE - 8th St from Rolla St to Pine St
Scale: 1" = 40' H
1" = 20' V

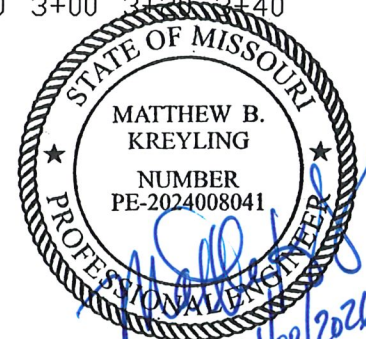

Date	APRIL 2026
Description	ROLLA STREET STORM SEWER UPGRADE
Rev.	1
Designed: CAF	Scale: 1" = 40'
Drawn: CAF	Proj. No.: 598
Checked: MBK	
City of Rolla Department of Public Works 901 North Elm Street Phone: 573-364-8659 www.rollacity.org	
ROLLA STREET STORM SEWER UPGRADE City of Rolla Public Works Department Storm Plan & Profile	
Sheet No.:	9

SEE SHEET 6

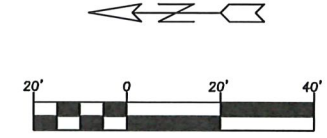
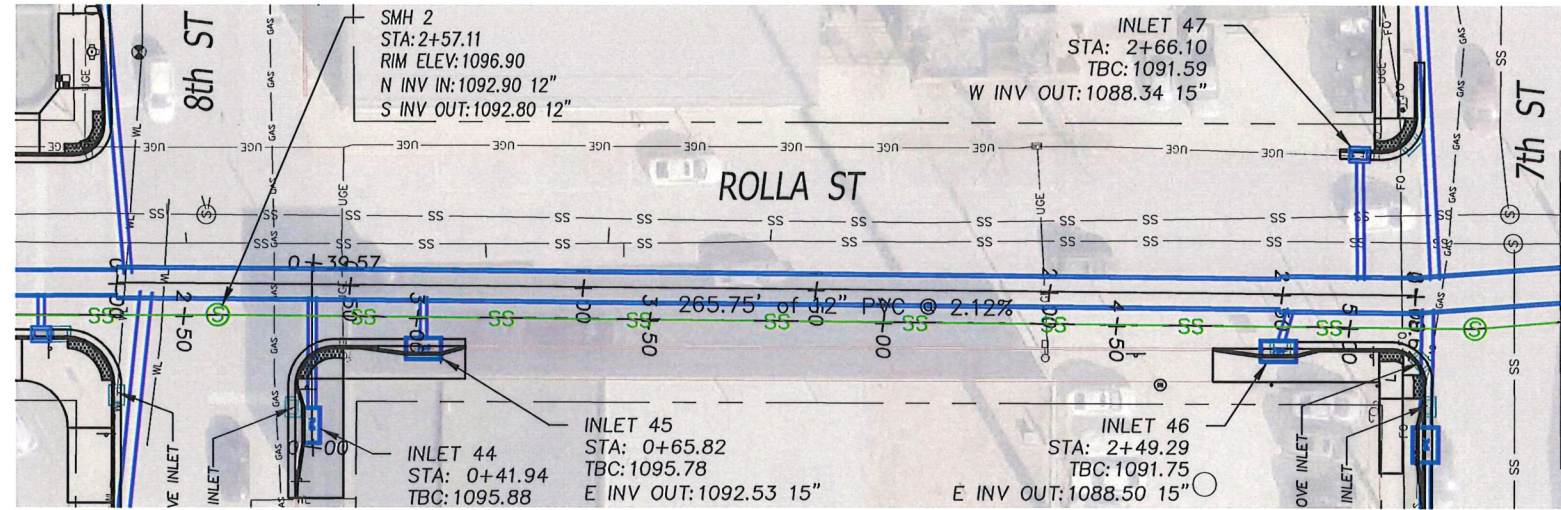

1 ROLLA STREET STORM PLAN - Rolla St from 7th St to 8th St
 Scale: 1" = 40' H

KEYED NOTES

- 1 CONTRACTOR SHALL ENSURE THAT ALL SPECIFIED TRAFFIC SIGNS REMAIN IN PLACE DURING CONSTRUCTION AND REMAIN VISIBLE AT ALL TIMES. CONTRACTOR SHALL INSTALL SIGN POST SLEEVES FOR SIGN UPGRADES AND RELOCATIONS.
- 2 ADJUST MANHOLE LID AND RING AS NEEDED BY OTHERS.
- 3 ADJUST WATER VALVE AS NEEDED BY OTHERS. CONTACT ROLLA MUNICIPAL UTILITIES REPRESENTATIVE FOR STANDARD DETAILS.
- 4 REMOVE AND DISCARD EXISTING DRAIN PIPE BY OTHERS.
- 5 CONTRACTOR SHALL ENSURE ALL PROPERTY PINS, RIGHT-OF-WAY MARKERS, MONUMENTS AND BENCH MARKS REMAIN UNDISTURBED AS PER MISSOURI REVISED STATUTES, CHAPTER 60 "COUNTY SURVEYORS AND LAND SURVEYS" SECTION 60.355. CONTRACTOR SHALL BE AWARE THAT VIOLATION OF THIS STATUTE IS CONSIDERED A CLASS B MISDEMEANOR. CONTRACTOR SHALL BE RESPONSIBLE FOR ALL COSTS ASSOCIATED WITH REESTABLISHMENT OF MONUMENTS OR MARKERS DISTURBED DURING CONSTRUCTION.
- 6 REMOVE AND RELOCATE EXISTING MAILBOXES BY OTHERS. CONTRACTOR SHALL ENSURE POSTAL SERVICE IS UNINTERRUPTED.
- 7 SAWCUT ASPHALT AT MATCH LINES BY OTHERS.

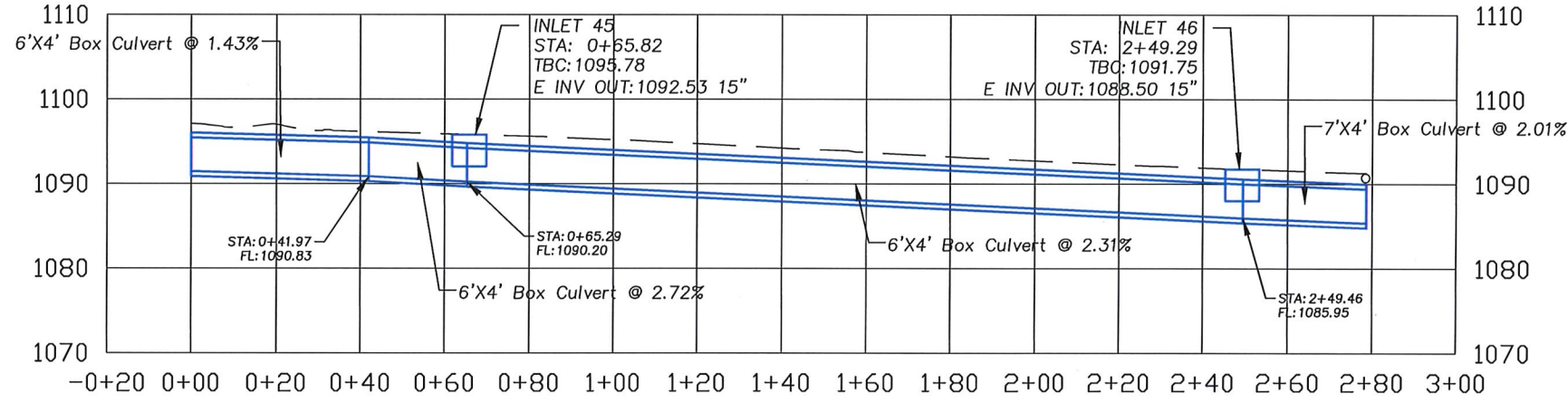

2 ROLLA STREET STORM PROFILE - Rolla St from 7th St to 8th St
 Scale: 1" = 40' H
 1" = 20' V

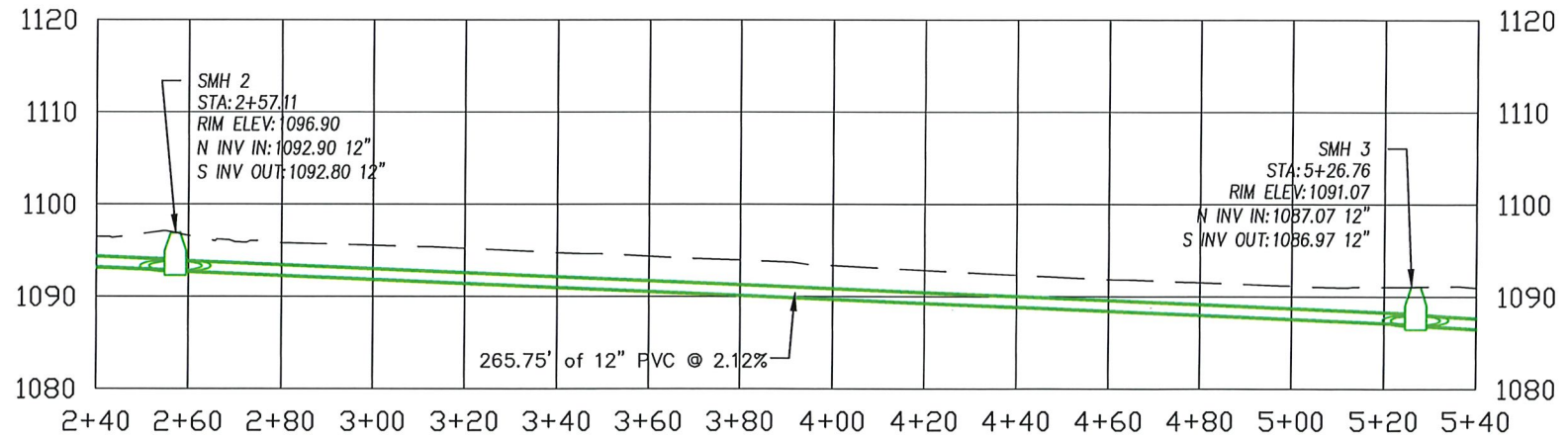

3 ROLLA STREET SANITARY PROFILE - Rolla St from 7th St to 8th St
 Scale: 1" = 40' H
 1" = 20' V

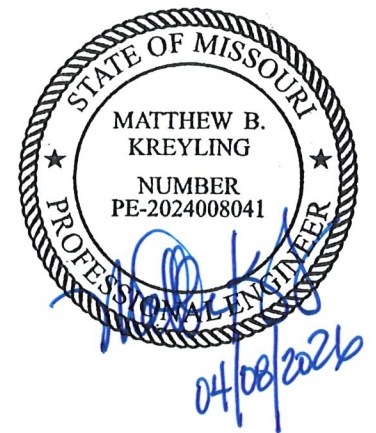

Date	APRIL 2026
Description	ROLLA STREET STORM SEWER UPGRADE
Rev.	
Designed: CAF	Scale: 1" = 40'
Drawn: CAF	Proj. No.: 598
Checked: MBK	

City of Rolla
 Department of Public Works
 901 North Elm Street
 Phone: 573-364-8659
 www.rollacity.org

ROLLA

ROLLA STREET STORM SEWER UPGRADE
 City of Rolla Public Works Department
 Storm & Sanitary Plan & Profile

Sheet No.: **10**

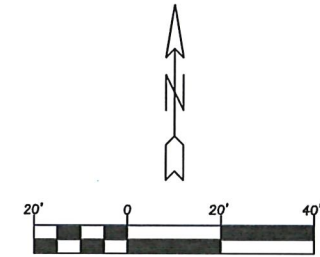
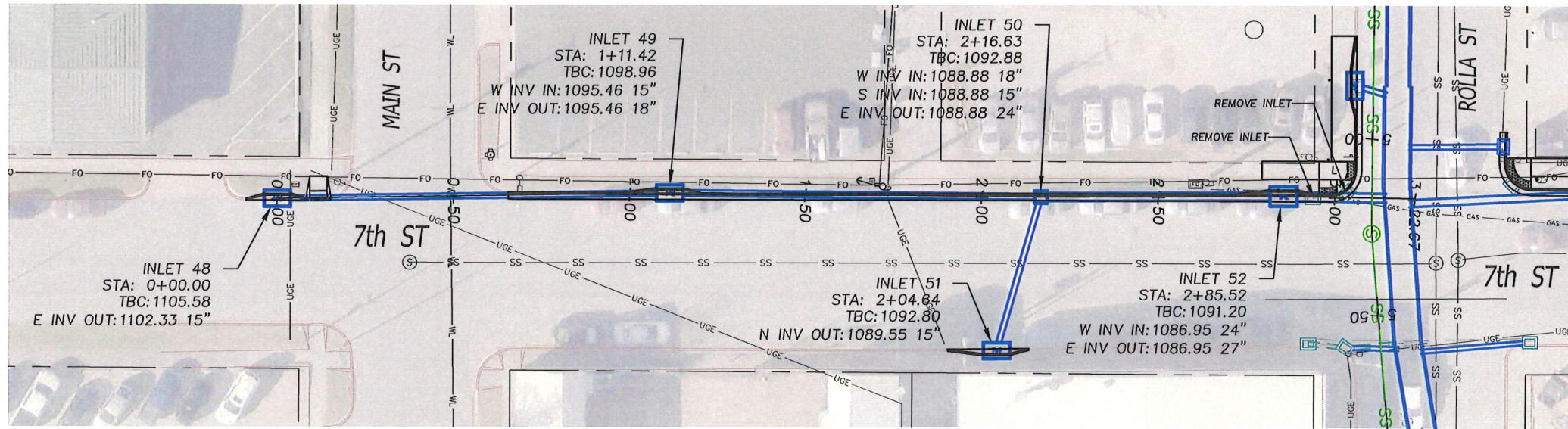

1 ROLLA STREET STORM PLAN - 7th St from Main St to Rolla St
11 Scale: 1" = 40' H

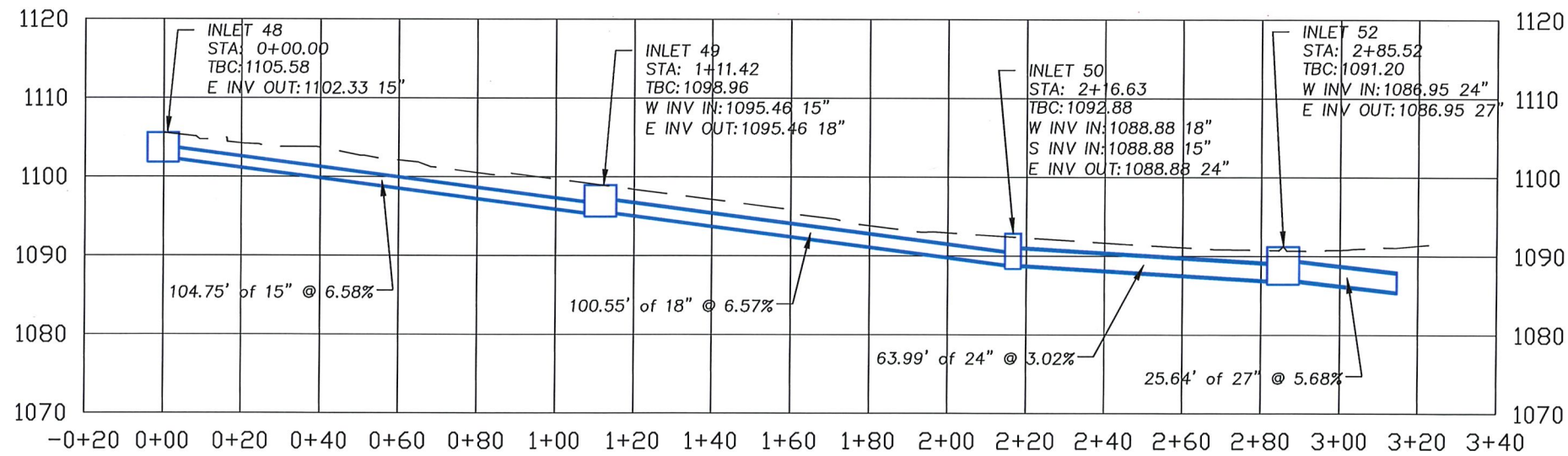

2 ROLLA STREET STORM PROFILE - 7th St from Main St to Rolla St
11 Scale: 1" = 40' H
 1" = 20' V



Designed: CAF	Date: APRIL 2026
Drawn: CAF	Scale: 1" = 40'
Checked: MBK	Proj. No.: 598
City of Rolla Department of Public Works 901 North Elm Street Phone: 573-364-8659 www.rollacity.org	
ROLLA	
ROLLA STREET STORM SEWER UPGRADE City of Rolla Public Works Department Storm Plan & Profile	
Sheet No.: 11	

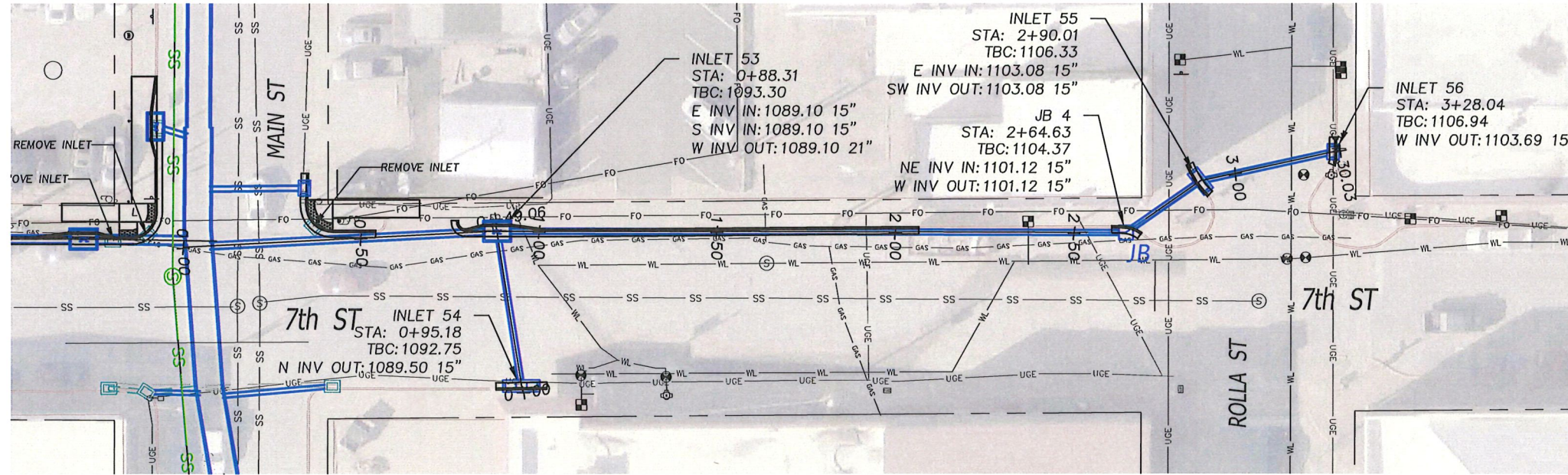

1 ROLLA STREET STORM PLAN - 7th St from Rolla St to Main St
 12 Scale: 1" = 40' H

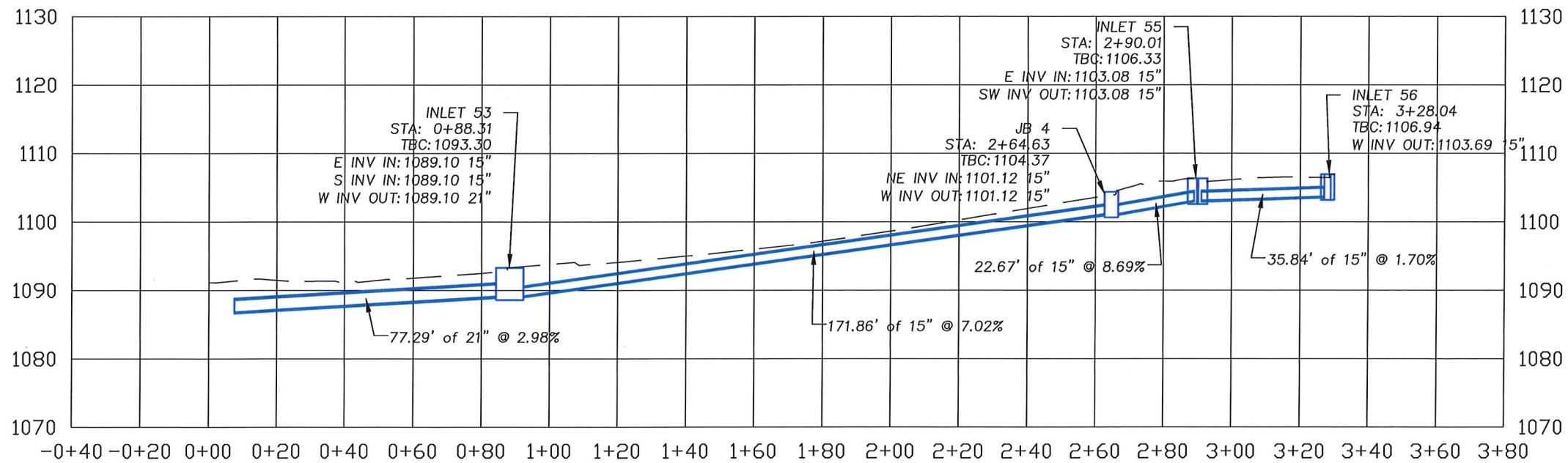

2 ROLLA STREET STORM PROFILE - 7th St from Rolla St to Main St
 12 Scale: 1" = 40' H
 1" = 20' V



Rev.	Description	Date

Designed: CAF	Date: APRIL 2026
Drawn: CAF	Scale: 1" = 40'
Checked: MBK	Proj. No.: 598

City of Rolla Department of Public Works 901 North Elm Street Phone: 573-364-8659 www.rollacity.org

ROLLA STREET STORM SEWER UPGRADE City of Rolla Public Works Department Storm Plan & Profile

Sheet No.:	12
------------	----

SEE SHEET 8

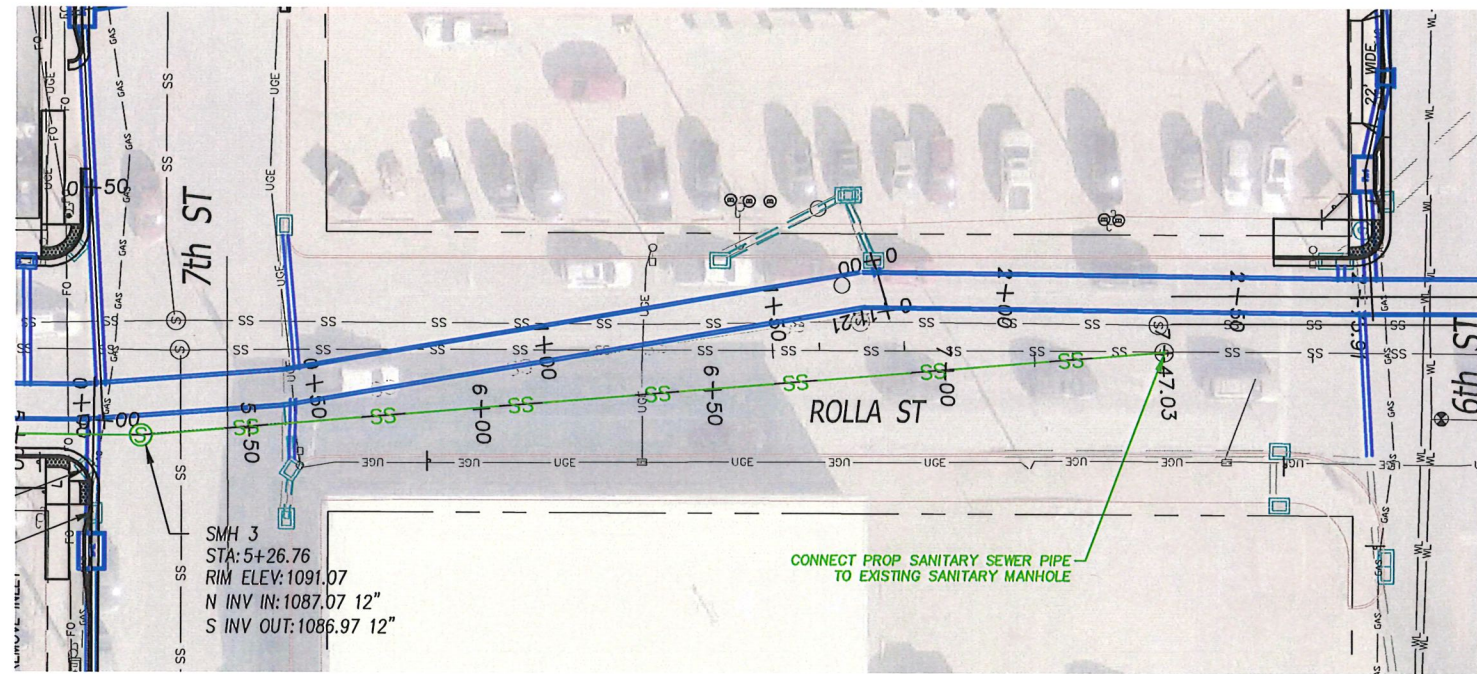

1 ROLLA STREET STORM PLAN - Rolla St from 6th St to 7th St
13 Scale: 1" = 40' H

KEYED NOTES

- 1 CONTRACTOR SHALL ENSURE THAT ALL SPECIFIED TRAFFIC SIGNS REMAIN IN PLACE DURING CONSTRUCTION AND REMAIN VISIBLE AT ALL TIMES. CONTRACTOR SHALL INSTALL SIGN POST SLEEVES FOR SIGN UPGRADES AND RELOCATIONS.
- 2 ADJUST MANHOLE LID AND RING AS NEEDED BY OTHERS.
- 3 ADJUST WATER VALVE AS NEEDED BY OTHERS. CONTACT ROLLA MUNICIPAL UTILITIES REPRESENTATIVE FOR STANDARD DETAILS.
- 4 REMOVE AND DISCARD EXISTING DRAIN PIPE BY OTHERS.
- 5 CONTRACTOR SHALL ENSURE ALL PROPERTY PINS, RIGHT-OF-WAY MARKERS, MONUMENTS AND BENCH MARKS REMAIN UNDISTURBED AS PER MISSOURI REVISED STATUTES, CHAPTER 60 "COUNTY SURVEYORS AND LAND SURVEYS", SECTION 60.355. CONTRACTOR SHALL BE AWARE THAT VIOLATION OF THIS STATUTE IS CONSIDERED A CLASS B MISDEMEANOR. CONTRACTOR SHALL BE RESPONSIBLE FOR ALL COSTS ASSOCIATED WITH REESTABLISHMENT OF MONUMENTS OR MARKERS DISTURBED DURING CONSTRUCTION.
- 6 REMOVE AND RELOCATE EXISTING MAILBOXES BY OTHERS. CONTRACTOR SHALL ENSURE POSTAL SERVICE IS UNINTERRUPTED.
- 7 SAWCUT ASPHALT AT MATCH LINES BY OTHERS.

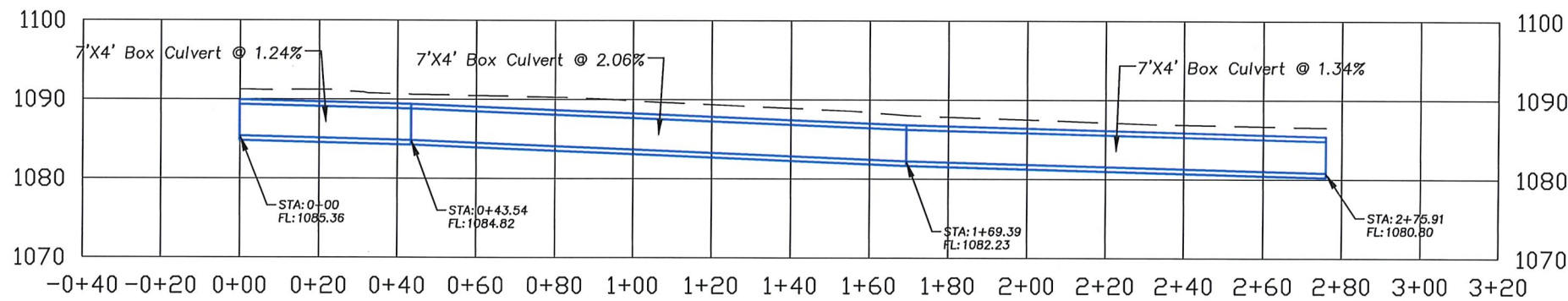

2 ROLLA STREET STORM PROFILE - Rolla St from 6th St to 7th St
13 Scale: 1" = 40' H
 1" = 20' V

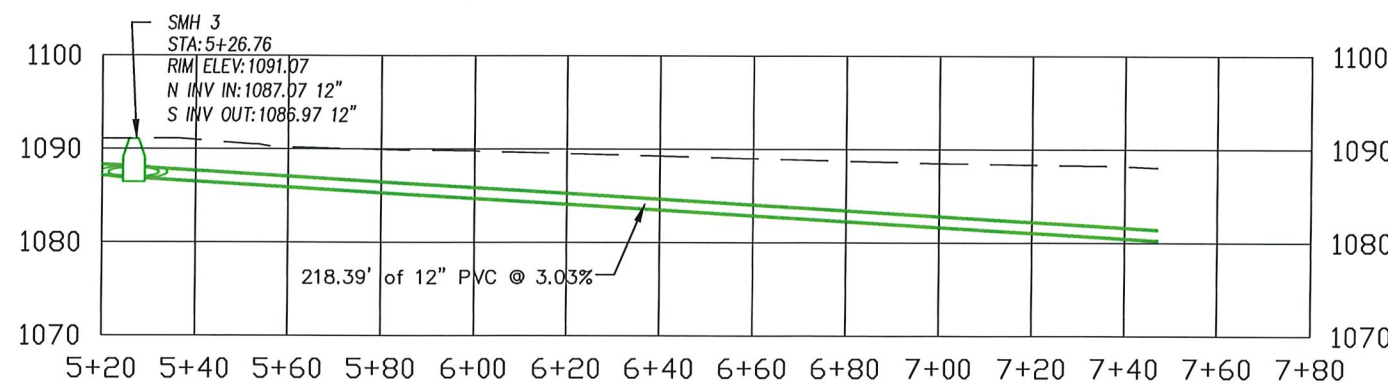

3 ROLLA STREET SANITARY PROFILE - Rolla St from 6th St to 7th St
13 Scale: 1" = 40' H
 1" = 20' V

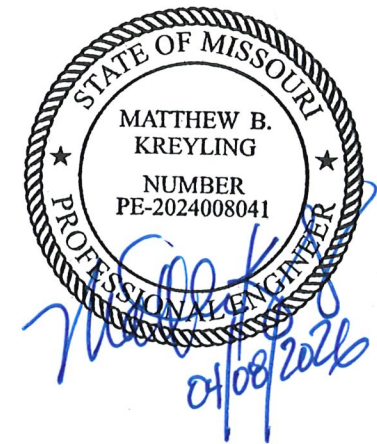

Rev.	Description	Date

Designed: CAF	Date: APRIL 2026
Drawn: CAF	Scale: 1" = 40'
Checked: MBK	Proj. No.: 598

City of Rolla	
Department of Public Works	
901 North Elm Street	
Phone: 573-364-8659	
www.rollacity.org	

ROLLA STREET STORM SEWER UPGRADE
City of Rolla Public Works Department
Storm & Sanitary Plan & Profile

Sheet No.:	13
------------	----

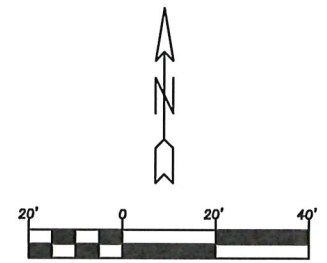
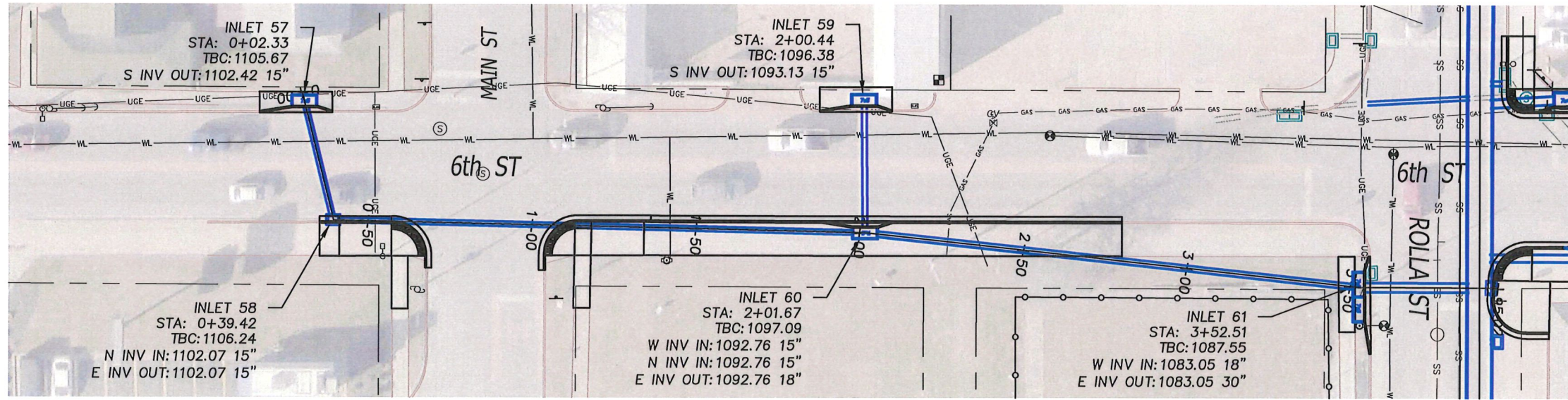

1
14 ROLLA STREET STORM PLAN - 6th St from Rolla St to Main St
Scale: 1" = 40' H

KEYED NOTES

- ① CONTRACTOR SHALL ENSURE THAT ALL SPECIFIED TRAFFIC SIGNS REMAIN IN PLACE DURING CONSTRUCTION AND REMAIN VISIBLE AT ALL TIMES. CONTRACTOR SHALL INSTALL SIGN POST SLEEVES FOR SIGN UPGRADES AND RELOCATIONS.
- ② ADJUST MANHOLE LID AND RING AS NEEDED BY OTHERS.
- ③ ADJUST WATER VALVE AS NEEDED BY OTHERS. CONTACT ROLLA MUNICIPAL UTILITIES REPRESENTATIVE FOR STANDARD DETAILS.
- ④ REMOVE AND DISCARD EXISTING DRAIN PIPE BY OTHERS.
- ⑤ CONTRACTOR SHALL ENSURE ALL PROPERTY PINS, RIGHT-OF-WAY MARKERS, MONUMENTS AND BENCH MARKS REMAIN UNDISTURBED AS PER MISSOURI REVISED STATUTES, CHAPTER 60 "COUNTY SURVEYORS AND LAND SURVEYS", SECTION 60.355. CONTRACTOR SHALL BE AWARE THAT VIOLATION OF THIS STATUTE IS CONSIDERED A CLASS B MISDEMEANOR. CONTRACTOR SHALL BE RESPONSIBLE FOR ALL COSTS ASSOCIATED WITH REESTABLISHMENT OF MONUMENTS OR MARKERS DISTURBED DURING CONSTRUCTION.
- ⑥ REMOVE AND RELOCATE EXISTING MAILBOXES BY OTHERS. CONTRACTOR SHALL ENSURE POSTAL SERVICE IS UNINTERRUPTED.
- ⑦ SAWCUT ASPHALT AT MATCH LINES BY OTHERS.

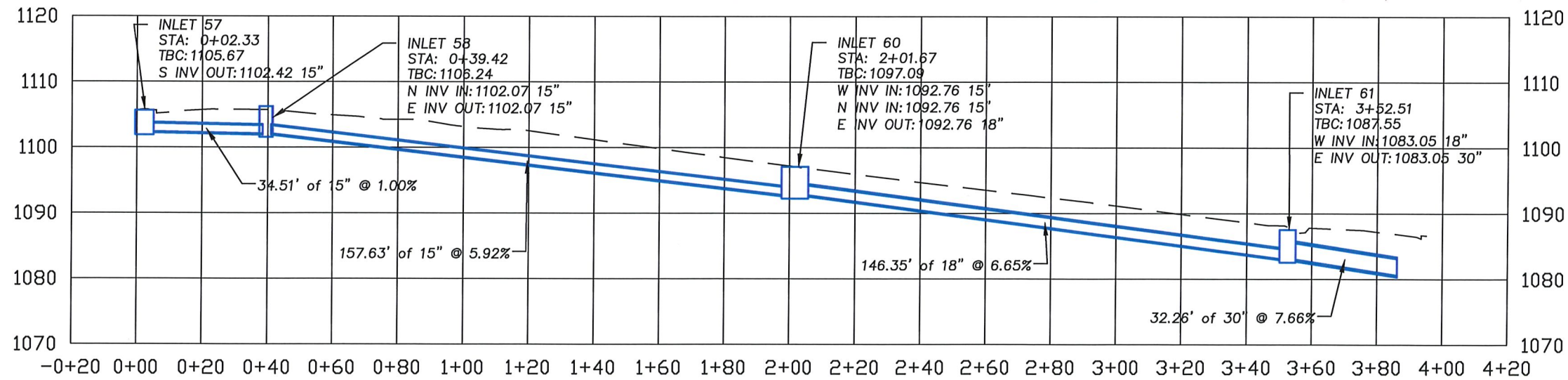
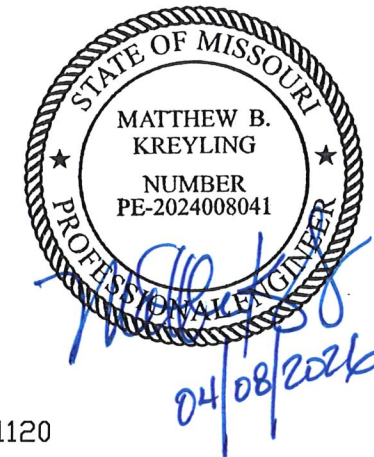

2
14 ROLLA STREET STORM PROFILE - 6th St from Rolla St to Main St
Scale: 1" = 40' H
1" = 20' V

Date	
Description	
Rev.	
Designed: CAF	Date: APRIL 2026
Drawn: CAF	Scale: 1" = 40'
Checked: MBK	Proj. No.: 598
City of Rolla Department of Public Works 901 North Elm Street Phone: 573-364-8659 www.rollacity.org	
ROLLA ROLLA STREET STORM SEWER UPGRADE City of Rolla Public Works Department Storm Plan & Profile	
Sheet No.:	14

SEE SHEET 8

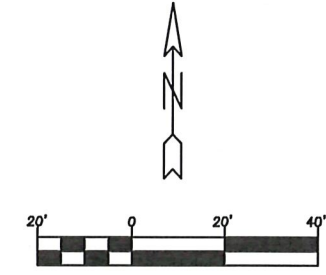
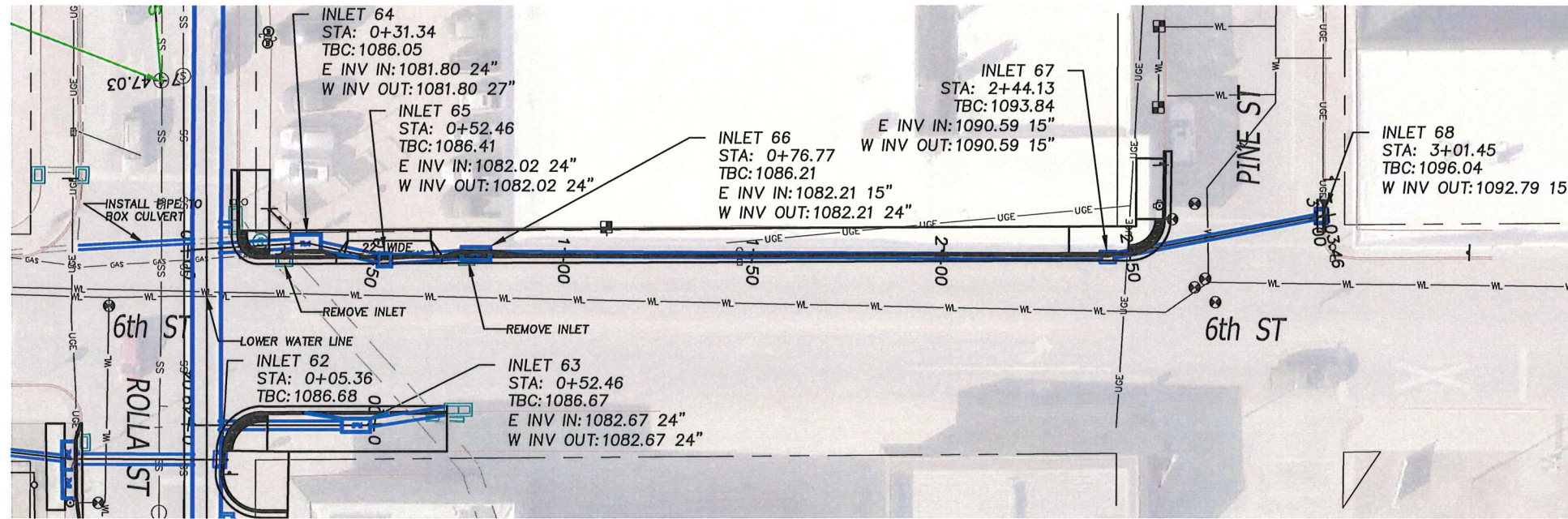

1 ROLLA STREET STORM PLAN - 6th St from Rolla St to Pine St
 Scale: 1" = 40' H

KEYED NOTES

- 1 CONTRACTOR SHALL ENSURE THAT ALL SPECIFIED TRAFFIC SIGNS REMAIN IN PLACE DURING CONSTRUCTION AND REMAIN VISIBLE AT ALL TIMES. CONTRACTOR SHALL INSTALL SIGN POST SLEEVES FOR SIGN UPGRADES AND RELOCATIONS.
- 2 ADJUST MANHOLE LID AND RING AS NEEDED BY OTHERS.
- 3 ADJUST WATER VALVE AS NEEDED BY OTHERS. CONTACT ROLLA MUNICIPAL UTILITIES REPRESENTATIVE FOR STANDARD DETAILS.
- 4 REMOVE AND DISCARD EXISTING DRAIN PIPE BY OTHERS.

- 5 CONTRACTOR SHALL ENSURE ALL PROPERTY PINS, RIGHT-OF-WAY MARKERS, MONUMENTS AND BENCH MARKS REMAIN UNDISTURBED AS PER MISSOURI REVISED STATUTES, CHAPTER 60 "COUNTY SURVEYORS AND LAND SURVEYS", SECTION 60.355. CONTRACTOR SHALL BE AWARE THAT VIOLATION OF THIS STATUTE IS CONSIDERED A CLASS B MISDEMEANOR. CONTRACTOR SHALL BE RESPONSIBLE FOR ALL COSTS ASSOCIATED WITH REESTABLISHMENT OF MONUMENTS OR MARKERS DISTURBED DURING CONSTRUCTION.
- 6 REMOVE AND RELOCATE EXISTING MAILBOXES BY OTHERS. CONTRACTOR SHALL ENSURE POSTAL SERVICE IS UNINTERRUPTED.
- 7 SAWCUT ASPHALT AT MATCH LINES BY OTHERS.

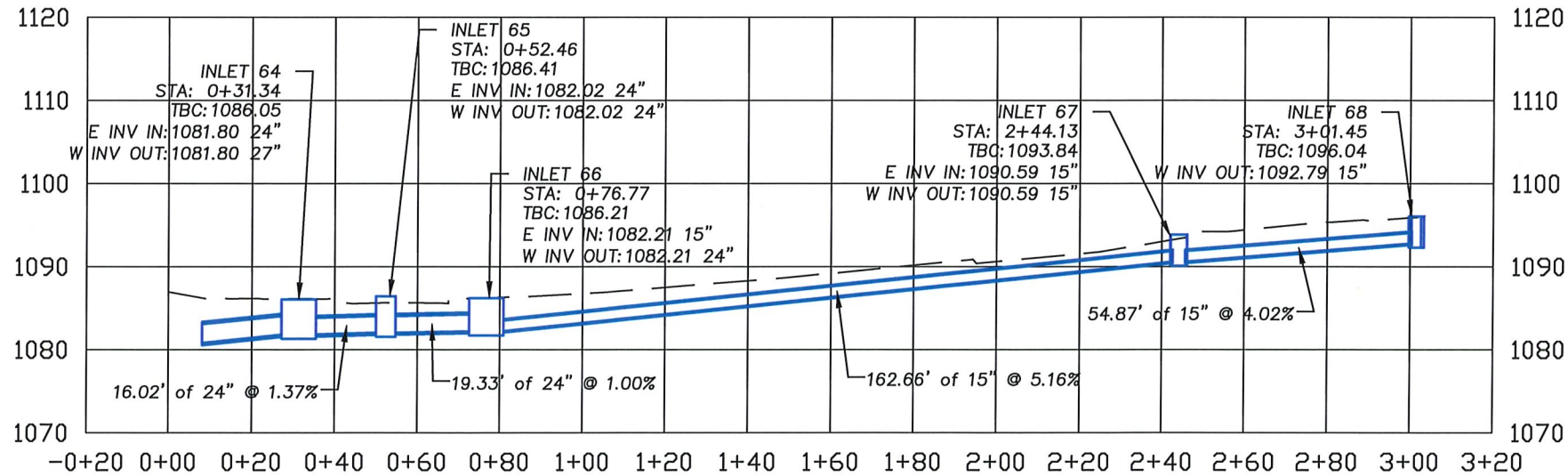

2 ROLLA STREET STORM PROFILE - 6th St from Rolla St to Pine St
 Scale: 1" = 40' H
 1" = 20' V

Date	
Description	
Rev.	
Designed: CAF	Date: APRIL 2026
Drawn: CAF	Scale: 1" = 40'
Checked: MBK	Proj. No.: 598
City of Rolla Department of Public Works 901 North Elm Street Phone: 573-364-8659 www.rollacity.org	
ROLLA	
ROLLA STREET STORM SEWER UPGRADE City of Rolla Public Works Department Storm Plan & Profile	
Sheet No.:	
15	

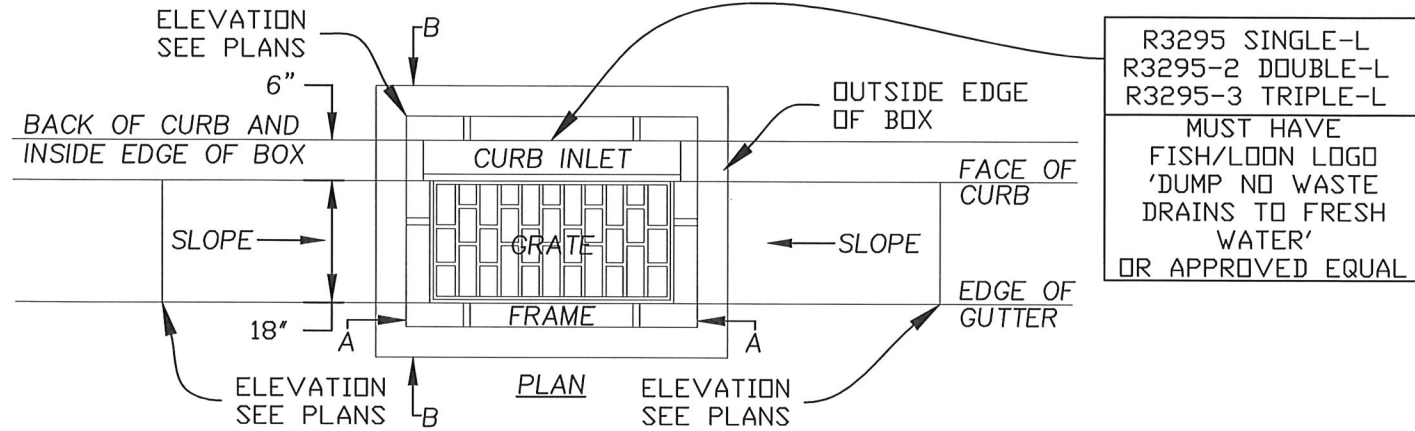

R3295 SINGLE-L
R3295-2 DOUBLE-L
R3295-3 TRIPLE-L
MUST HAVE
FISH/LOON LOGO
'DUMP NO WASTE
DRAINS TO FRESH
WATER'
OR APPROVED EQUAL

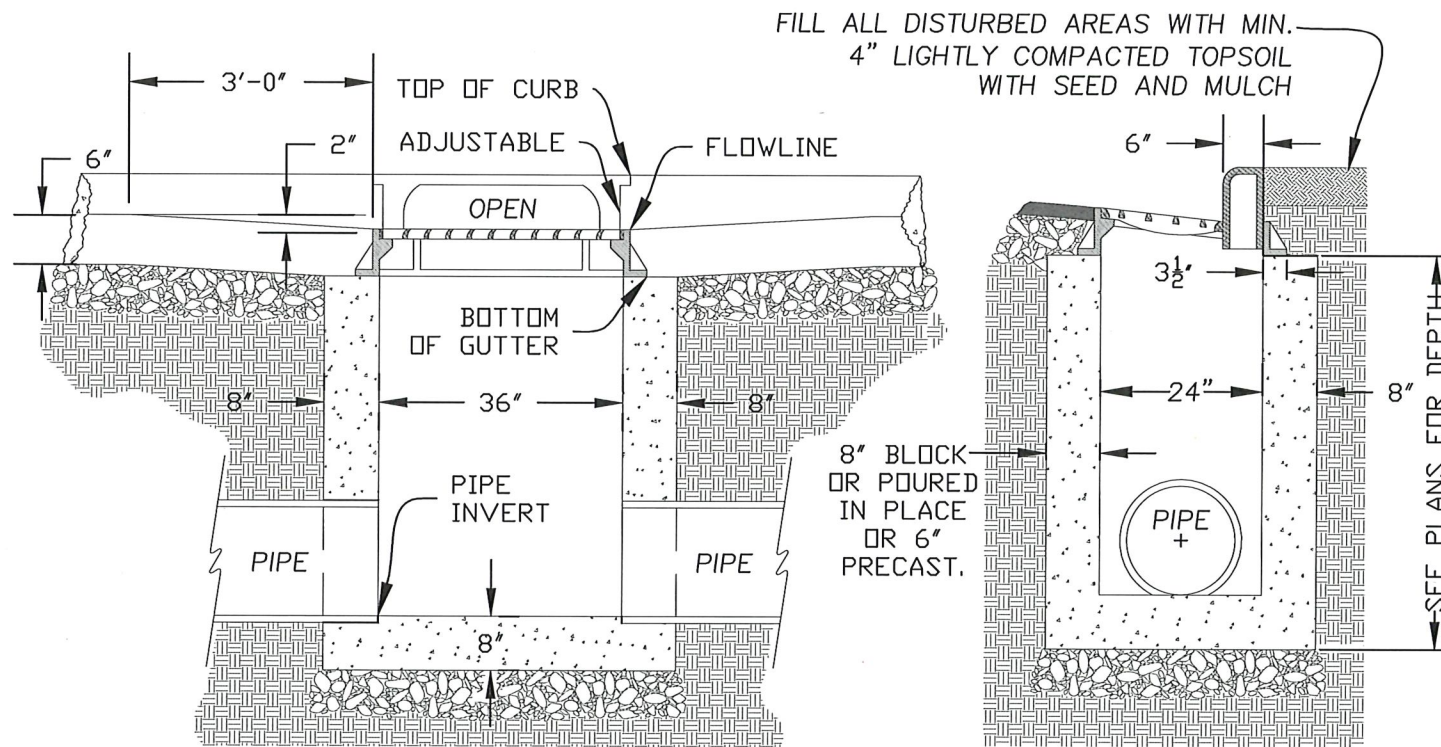

SECTION A-A

SECTION B-B

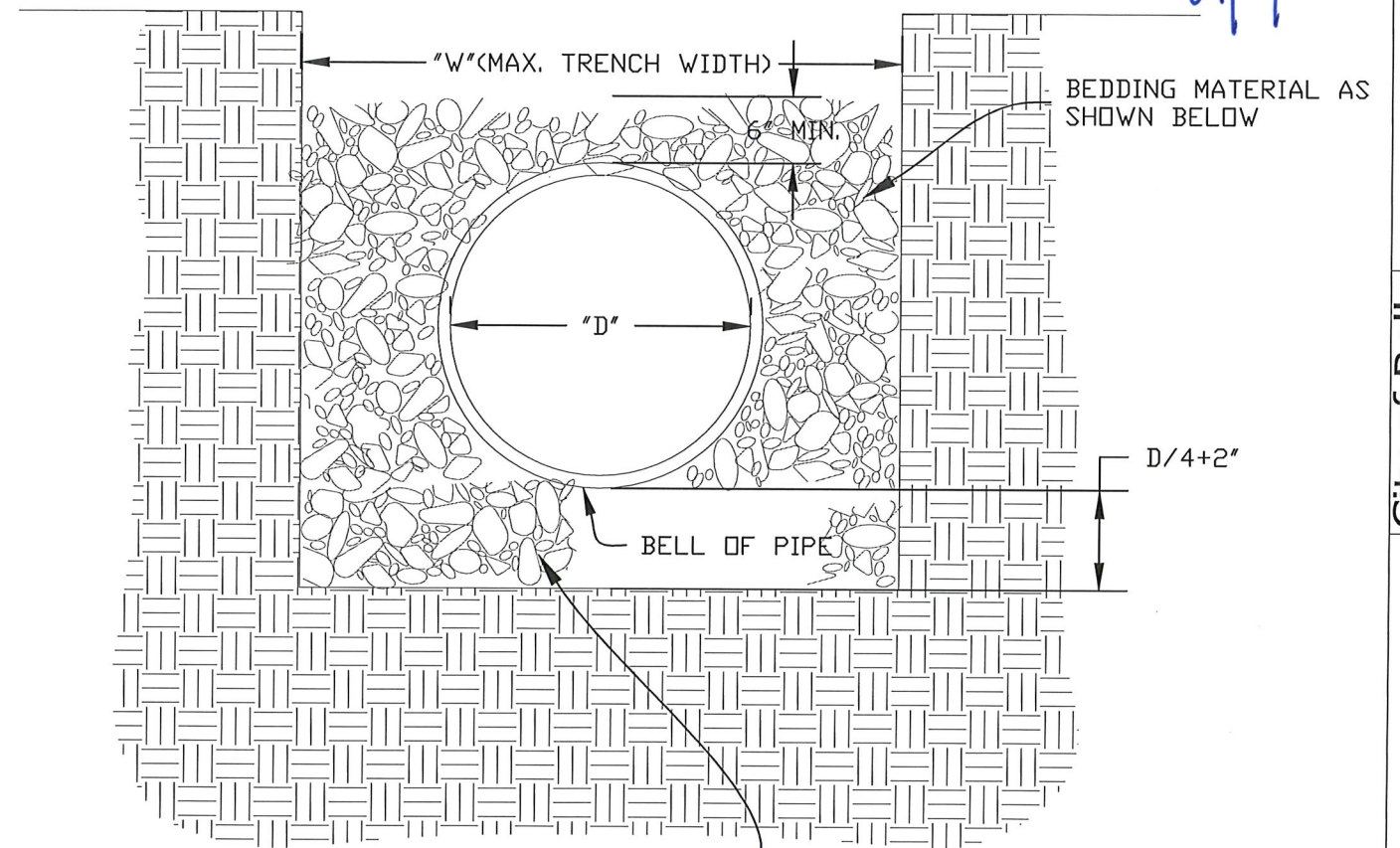

SHAPE BEDDING PRIOR TO INSTALLATION OF PIPE TO A DEPTH OF $D/4+2"$

NOTES:

WALL CONSTRUCTION SHALL BE 8" POURED IN PLACE CONCRETE, 8"Tx8"Hx16"L CONCRETE BLOCK GROUTED SOLID, OR 6" PRECAST CONCRETE.

BASE CONSTRUCTION SHALL BE POURED IN PLACE CONCRETE FORMED TO DIMENSION SHOWN.

CONCRETE SHALL BE 6 BAG MIX (4,000 PSI) WITH MINIMUM SLUMP OF 1 INCH AND MAXIMUM SLUMP OF 4 INCHES.

MAXIMUM TRENCH WIDTH	
SEWER SIZE "D"	MAXIMUM TRENCH WIDTH "W"
8"	24"
10"	24"
12"	30"
15"	30"
18"	36"
21"	42"
24"	48"

CRUSHED LIMESTONE BEDDING		
GRADATION IN PERCENTAGES BY WEIGHT PASSING SQUARE MESH SCREENS		
SCREEN SIZE	% PASSING	RETAINED
1"	100%	-
3/4"	95%	-
NO. 4	-	95%



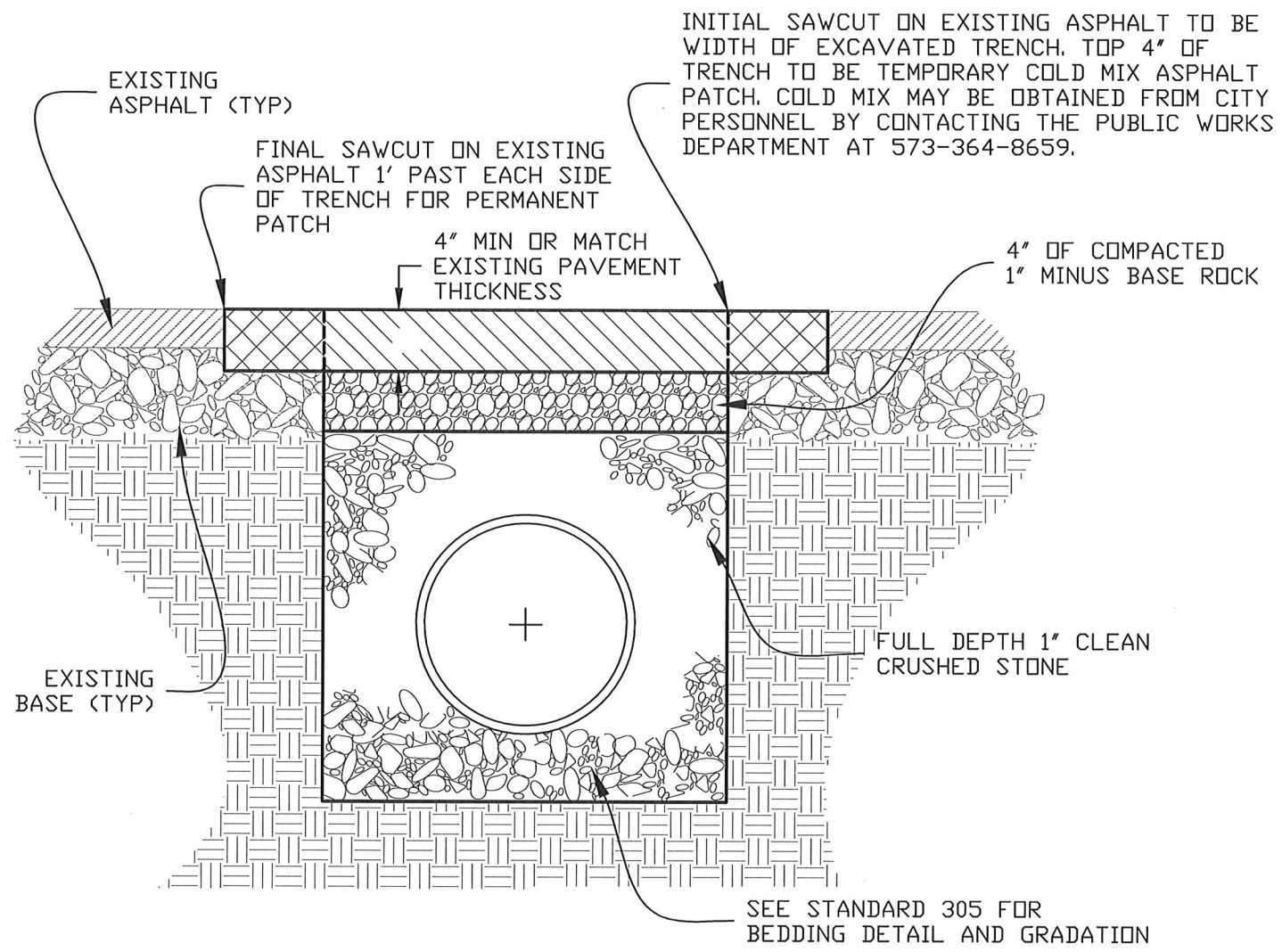

NOTES:

24 HOUR NOTICE TO PUBLIC WORKS DEPARTMENT IS REQUIRED BEFORE DIGGING IN THE RIGHT OF WAY.

BP1 ASPHALTIC CONCRETE SHALL BE COMPACTED IN PLACE IN MAXIMUM LIFTS OF 3 INCHES.

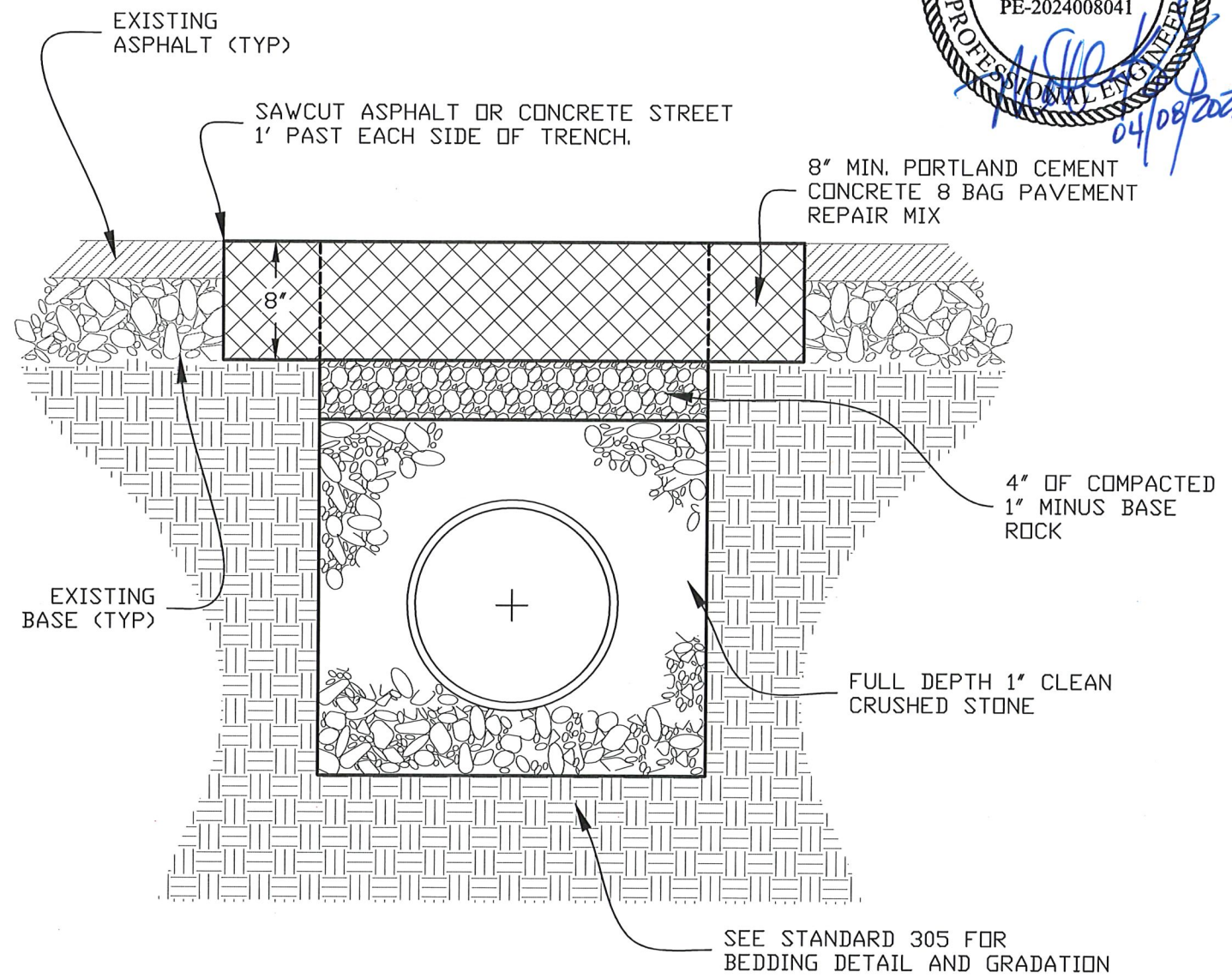

NOTES:

24 HOUR NOTICE TO PUBLIC WORKS DEPARTMENT IS REQUIRED BEFORE DIGGING IN THE RIGHT OF WAY.

PORTLAND CEMENT CONCRETE REQUIRES A MINIMUM OF 4 HOURS CURING TIME BEFORE BEING OPENED TO TRAFFIC. SURFACE SHALL BE BROOM FINISHED.



Date	
Description	
Rev	
Designed: CAF	Date: JULY 2025
Drawn: CAF	Scale: 1" = 40'
Checked: MBK	Proj. No.: 598
City of Rolla Department of Public Works 901 North Elm Street Phone: 573-364-8659 www.rollacity.org	
ROLLA	
ROLLA STREET STORM SEWER UPGRADE City of Rolla Public Works Department Standard Details	
Sheet No.:	19

CONSTRUCTION JOINT 1" DEEP AND GROOVED OR SAWCUT AT END OF TAPER PRIOR TO CRACKING. FOR DRIVE APRONS EXCEEDING 12' WIDE, CONSTRUCTION JOINTS SHALL BE EVENLY SPACED ACROSS APRON AT INCREMENTS NO GREATER THAN 12'6". ADDITIONAL EXPANSION JOINTS SHALL BE USED IF APRON IS POURED IN SEPARATE POURS. FOR DRIVE APRONS EXCEEDING 25' WIDE, EXPANSION JOINTS SHALL BE EVENLY SPACED ACROSS APRON AT INCREMENTS NO GREATER THAN 25'.

RESIDENTIAL DRIVE APRONS EXCEEDING 24' WIDE MUST BE APPROVED BY CITY ENGINEER.

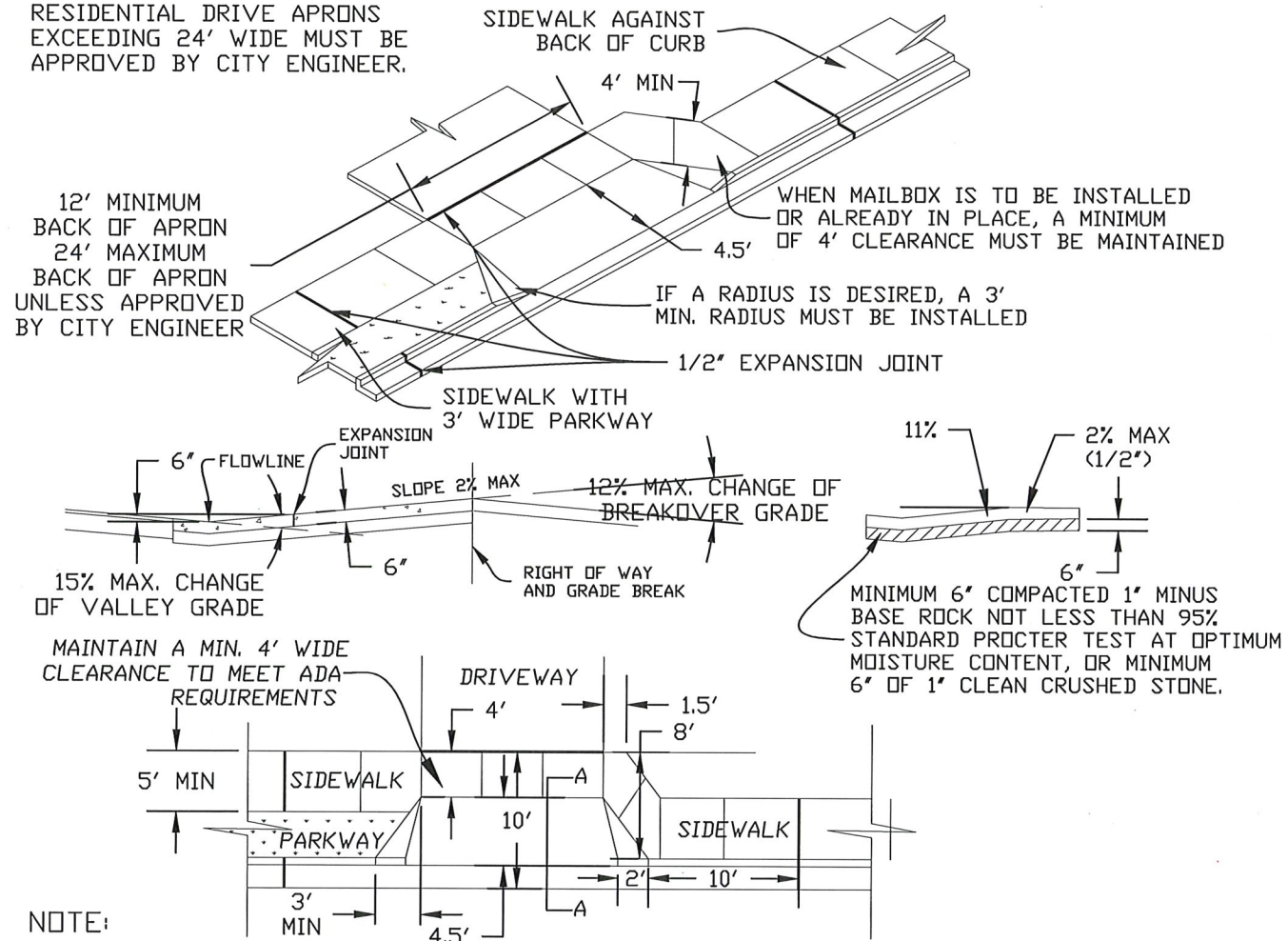

NOTE:

WHEN INSTALLING A NEW CONCRETE DRIVE AT EXISTING CONCRETE CURB AND GUTTER, THE ENTIRE CURB AND GUTTER SECTION IN THE AREA OF THE NEW DRIVE MUST BE REMOVED BY EITHER SAWCUTTING OR REMOVING TO AN EXISTING JOINT.

CONCRETE SHALL BE 6 BAG MIX (4,000 PSI) WITH SLUMP TEST LIMIT OF NOT LESS THAN 2 INCHES NOR MORE THAN 4 INCHES.

COLD WEATHER CONCRETE PROCEDURE MUST BE APPROVED BY CITY ENGINEER.

AN EXCAVATION PERMIT IS REQUIRED TO DIG IN PUBLIC RIGHT OF WAY. PERMIT SHALL BE OBTAINED FROM THE CITY OF ROLLA COMMUNITY DEVELOPMENT DEPARTMENT AT (573) 364-5333. AN INSPECTION IS REQUIRED BEFORE POURING ANY CONCRETE IN PUBLIC RIGHT OF WAY. CONTACT THE CITY OF ROLLA PUBLIC WORKS DEPARTMENT AT (573) 364-8659 FOR INSPECTION.

CONSTRUCTION JOINT 1" DEEP AND GROOVED OR SAWCUT AT END OF TAPER PRIOR TO CRACKING. FOR DRIVE APRONS EXCEEDING 12' WIDE, CONSTRUCTION JOINTS SHALL BE EVENLY SPACED ACROSS APRON AT INCREMENTS NO GREATER THAN 12'6". ADDITIONAL EXPANSION JOINTS SHALL BE USED IF APRON IS POURED IN SEPARATE POURS. FOR DRIVE APRONS EXCEEDING 25' WIDE, EXPANSION JOINTS SHALL BE EVENLY SPACED ACROSS APRON AT INCREMENTS NO GREATER THAN 25'. RESIDENTIAL DRIVE APRONS EXCEEDING 24' WIDE MUST BE APPROVED BY CITY ENGINEER.

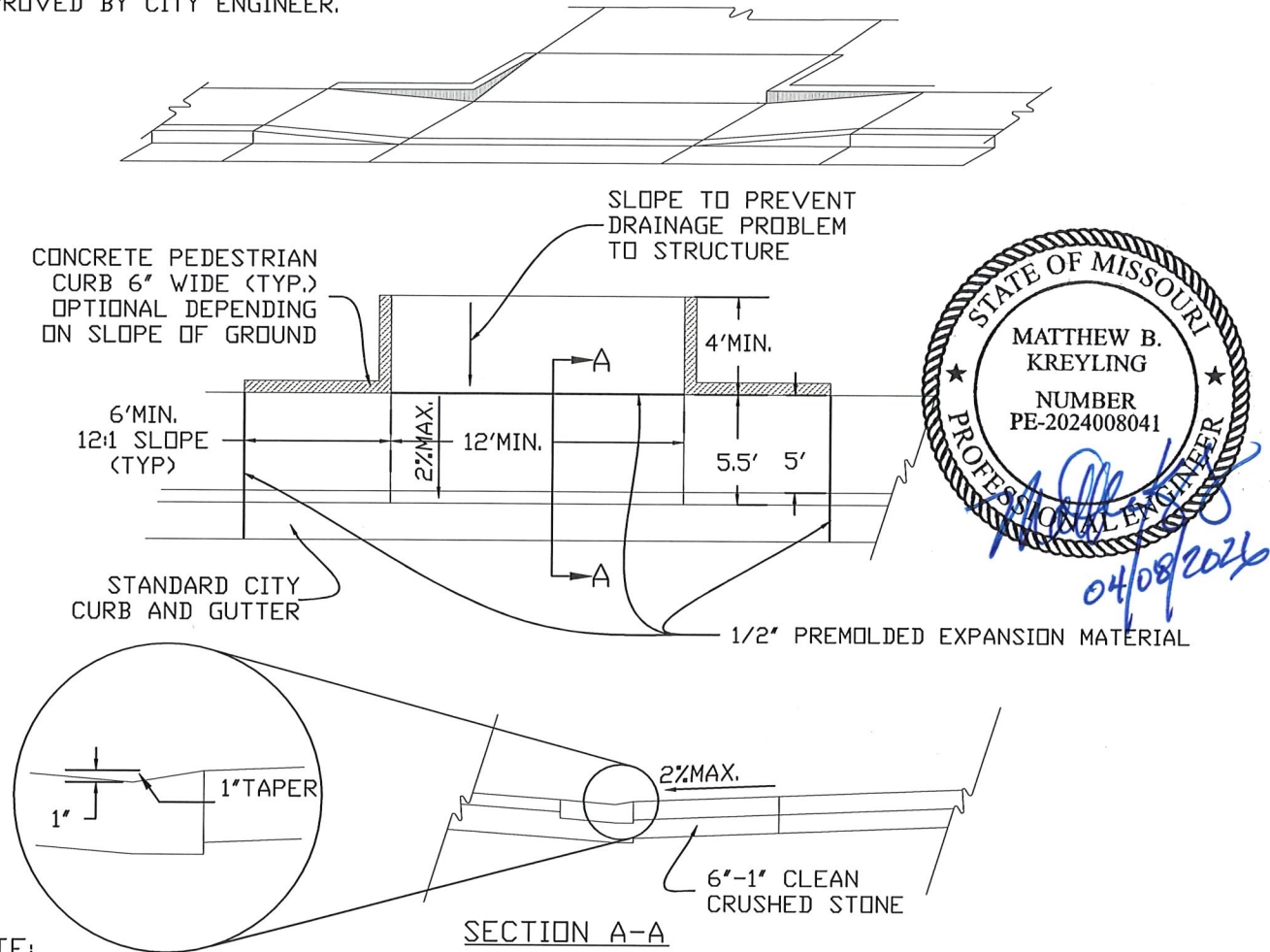

NOTE:

WHEN INSTALLING A NEW CONCRETE DRIVE AT EXISTING CONCRETE CURB AND GUTTER, THE ENTIRE CURB AND GUTTER SECTION IN THE AREA OF THE NEW DRIVE MUST BE REMOVED BY EITHER SAWCUTTING OR REMOVING TO AN EXISTING JOINT.

CONCRETE SHALL BE 6 BAG MIX (4,000 PSI) WITH SLUMP TEST LIMIT OF NOT LESS THAN 2 INCHES NOR MORE THAN 4 INCHES.

COLD WEATHER CONCRETE PROCEDURE MUST BE APPROVED BY CITY ENGINEER.

AN EXCAVATION PERMIT IS REQUIRED TO DIG IN PUBLIC RIGHT OF WAY. PERMIT SHALL BE OBTAINED FROM THE CITY OF ROLLA COMMUNITY DEVELOPMENT DEPARTMENT AT (573) 364-5333. AN INSPECTION IS REQUIRED BEFORE POURING ANY CONCRETE IN PUBLIC RIGHT OF WAY. CONTACT THE CITY OF ROLLA PUBLIC WORKS DEPARTMENT AT (573) 364-8659 FOR INSPECTION.

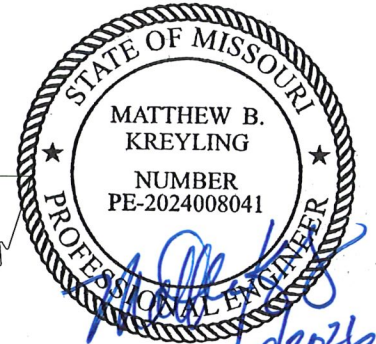

Date	
Description	
Rev.	
Designed: CAF	Date: JULY 2025
Drawn: CAF	Scale: 1" = 40'
Checked: MBK	Proj. No.: 598
City of Rolla Department of Public Works 901 North Elm Street Phone: 573-364-8659 www.rollacity.org	
ROLLA STREET STORM SEWER UPGRADE City of Rolla Public Works Department Standard Details	
Sheet No.:	
21	

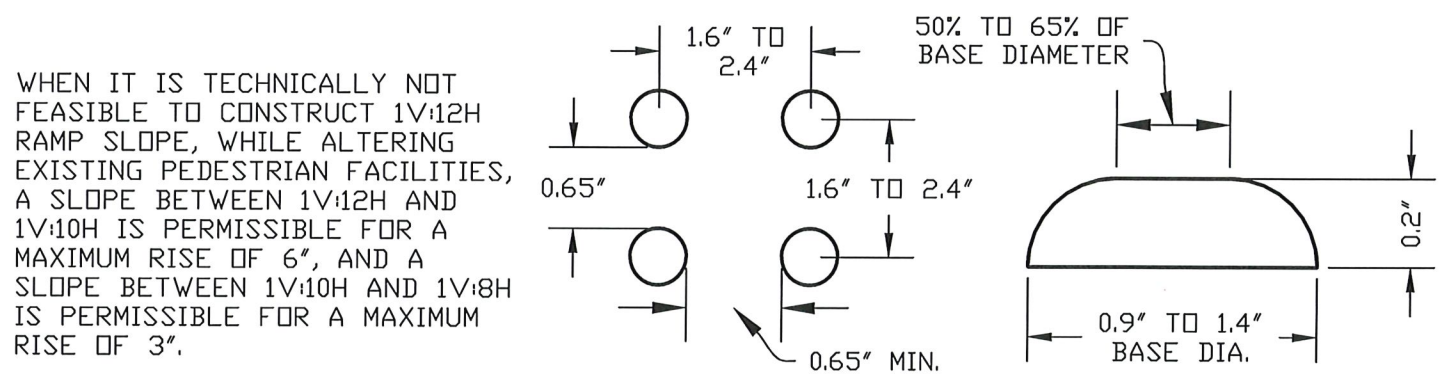
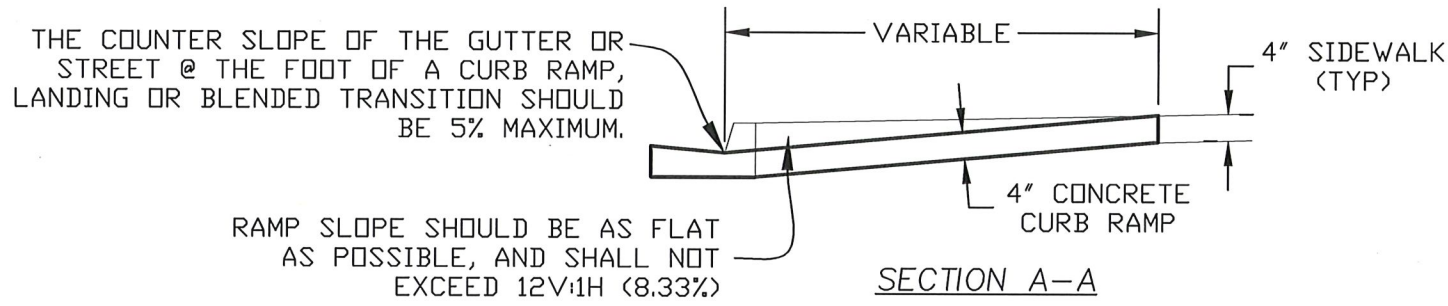
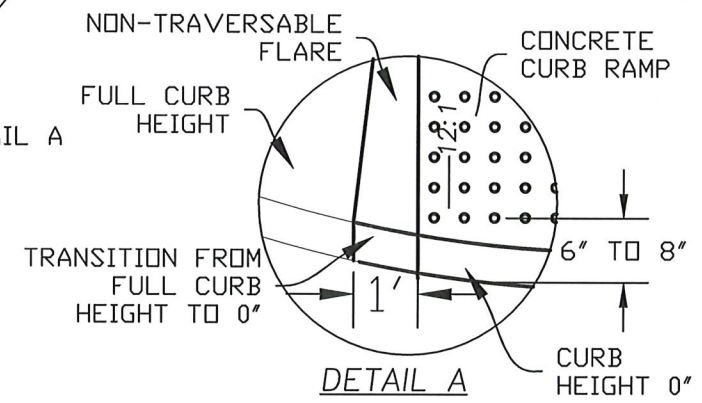
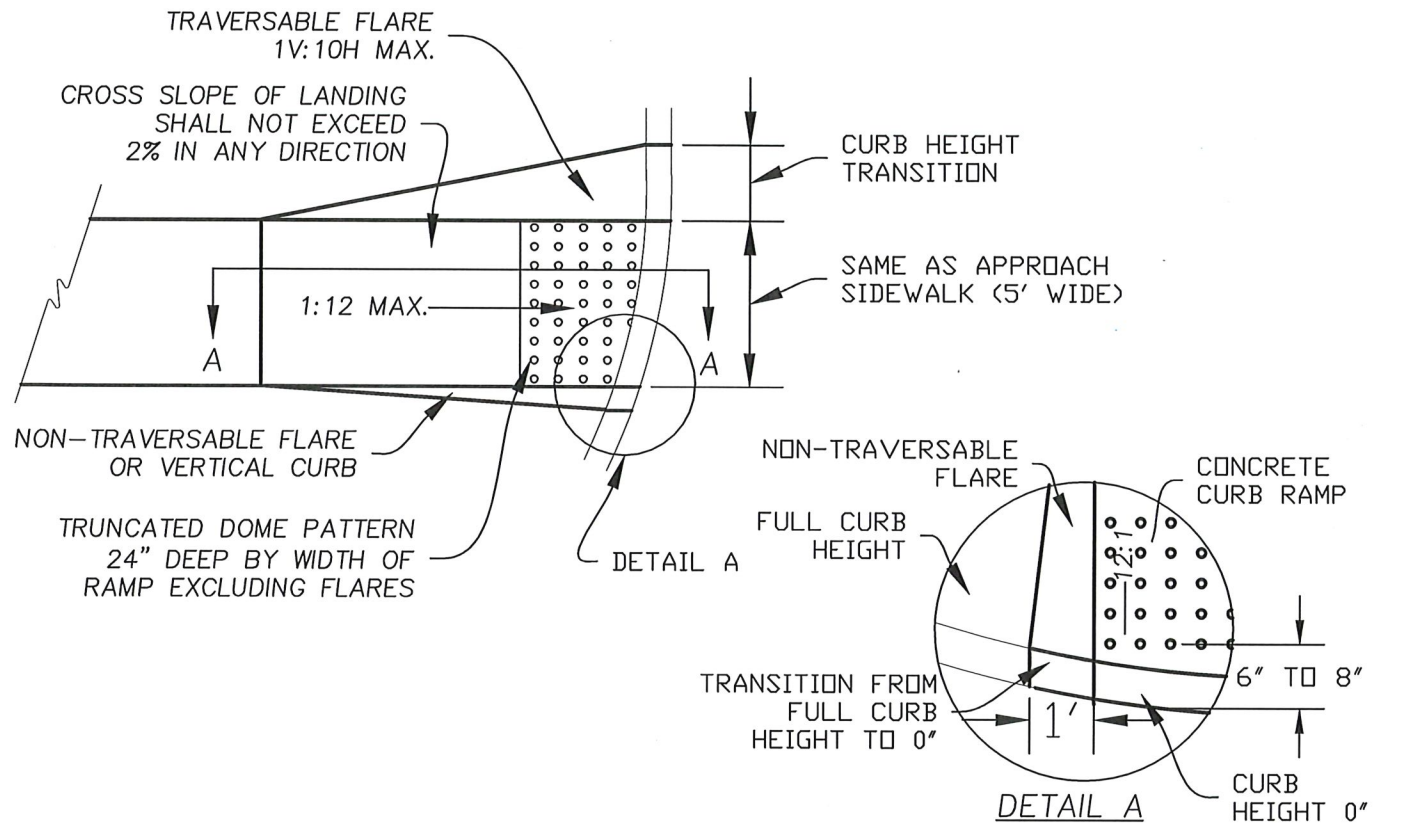

ALL DOMES WITHIN CITY R.O.W. MUST BE BARE CAST IRON WET SET.

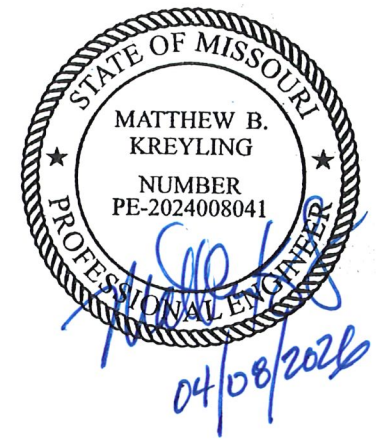

Date	
Description	
Rev.	
Designed: CAF	Date: JULY 2025
Drawn: CAF	Scale: 1" = 40'
Checked: MBK	Proj. No.: 598
City of Rolla Department of Public Works 901 North Elm Street Phone: 573-364-8659 www.rollacity.org	
ROLLA	
ROLLA STREET STORM SEWER UPGRADE City of Rolla Public Works Department Standard Details	
Sheet No.:	22



GENERAL NOTES:

1. THE FIRST DIMENSION LISTED IN THE CONSTRUCTION NOTES IS THE "L" DIMENSION. THE SECOND DIMENSION IS THE "W" DIMENSION. F 'S LISTED ON THE PROJECT PLANS ARE LISTED AT THE INSIDE FACE OF THE WALL.
2. FLOOR OF INLET SHALL BE SHAPED WITH INVERT TO PROVIDE SMOOTH FLOW.
3. LOCATE MH RING AND COVER OVER OUTLET.
4. CAST IRON STEPS SHALL BE SPACED AT 1'4" O.C. VERTICALLY.
5. BEVEL ALL EXPOSED EDGES WITH 3/4" CHAMFER OR 1/2" TOOLED EDGE.
6. ON-GRADE INLETS SHALL CONFORM TO THE STREED GRAD AND SUMP INLETS SHALL BE LEVEL.
7. THE SUMS OF "L" & "W" SHALL NOT EXCEED 14' WITHOUT SPECIAL DESIGN. (SEE PROJECT PLANS FOR DETAILS.)
8. RING & COVER TO BE NEENAH R-1537, CLAY & BALLEY #2020, DEETER #2016, OR APPROVED EQUAL. (CASTING MAY VARY BY MUNICIPALITY, REFER TO PLANS & CONTRACT DOCUMENTS.)

* EAST JORDAN IS AN APPROVED MANUFACTURER FOR CASTINGS.

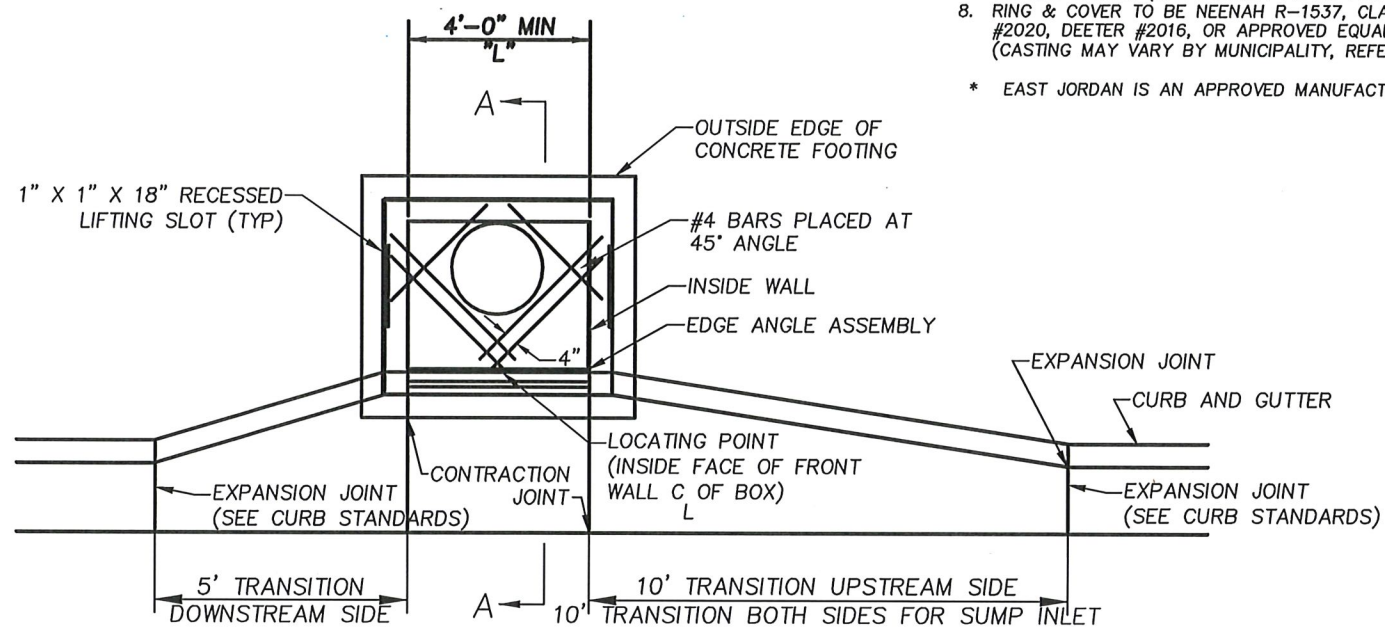

PLAN

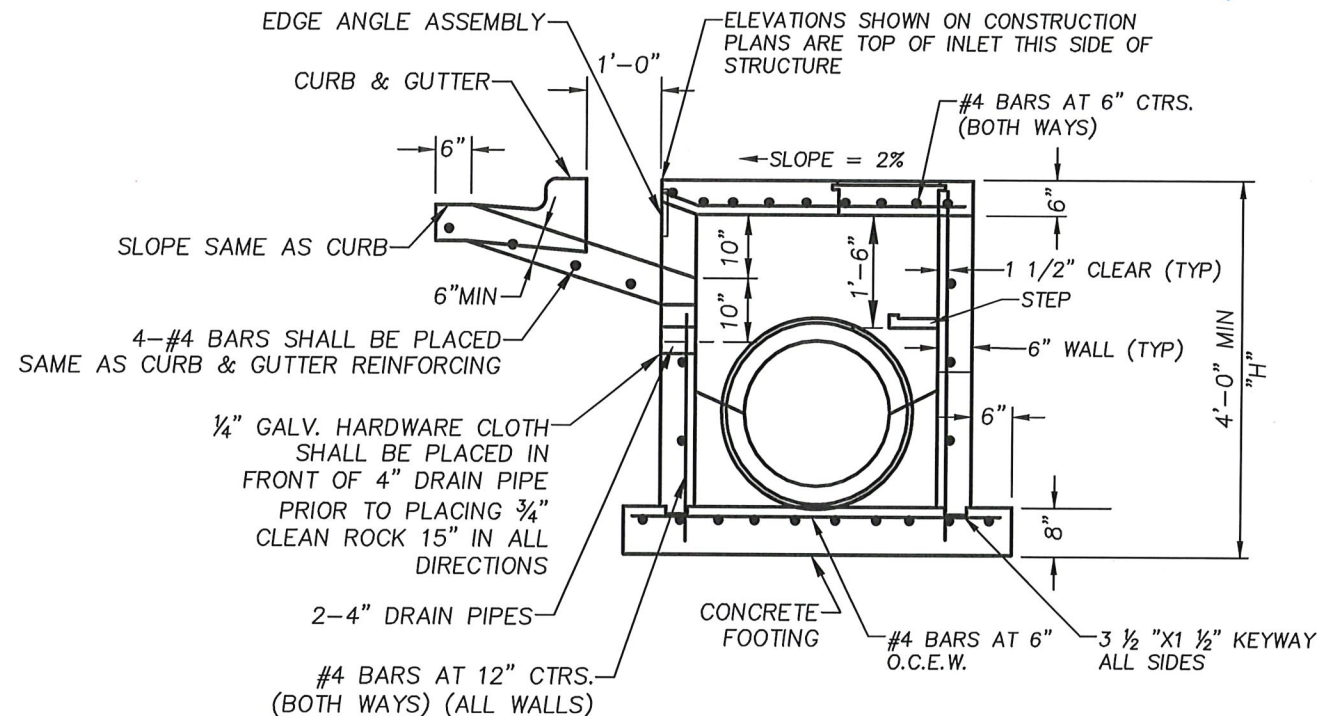

SECTION A-A

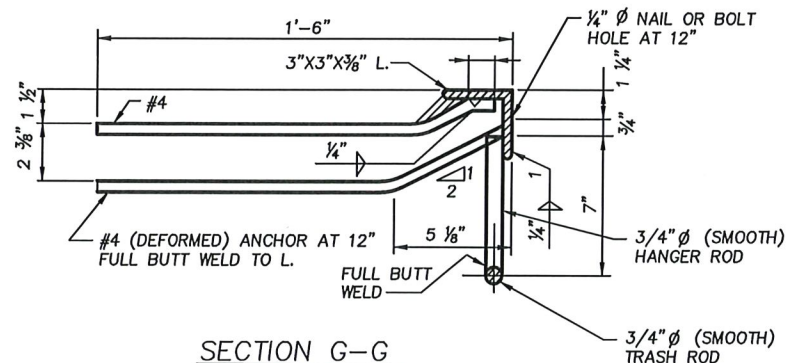

SECTION G-G

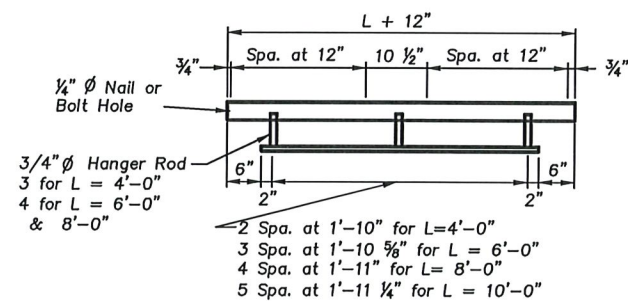

FRONT ELEV.

Note: Nails or bolts used to anchor L to form shall be removed or cut-off flush w/surface of L.

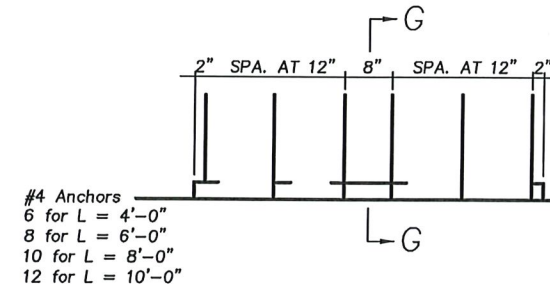

PLAN

TYPE 3 CURB INLET DETAILS

NTS

Date	
Description	
Rev.	
Designed: CAF	Date: JULY 2025
Drawn: CAF	Scale: 1" = 40'
Checked: MBK	Proj. No.: 598
City of Rolla Department of Public Works 901 North Elm Street Phone: 573-364-8659 www.rollacty.org	
ROLLA	
ROLLA STREET STORM SEWER UPGRADE City of Rolla Public Works Department Standard Details - Type 3 Curb Inlet	
Sheet No.:	23

